

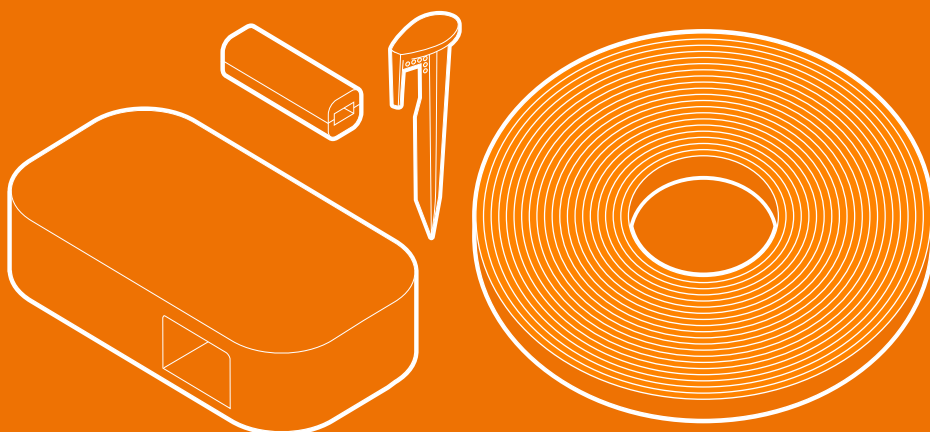

WORX
it's your nature

Off Limits
get started

In the box



From your toolbox



LANDROID

UNMANNED
MOWING
VEHICLE

WA0863

compatible only with Landroid models:
WR130E/WR141E/WR142E/WR143E/WR153E/WR155

WA0892

compatible only with Landroid models:
WR165E/WR167E/WR148E/WR147E.1/WR147E

TABLE OF CONTENTS

Welcome

p. 03 Contact information

Safety first

p. 04 Important safety instructions

Get familiar with

p. 05 What's in the box

p. 06 How it works

Getting started

p. 07 Installation

Quick reference

p. 15 Trouble shooting

p. 15 Technical data

p. 16 Declaration of Conformity

Thank you for purchasing a Worx Off Limits.

We're here to help:



Support

www.worx-europe.com/support

Landroid Owner's Site

<https://account.worxlandroid.com/login>

**WARNING:**

Read all safety warnings and all instructions.

Failure to follow the warnings and instructions may result in electric shock, fire and/or serious injury.

Carefully read the instructions for the safe operation of the machine.

Save all warnings and instructions for future reference.

Symbols



Warning



Read the operator's manual.



Waste electrical products should not be disposed of with household waste.
Please recycle where facilities exist.
Check with your Local Authorities or retailer for recycling advice.

WHAT'S IN THE BOX

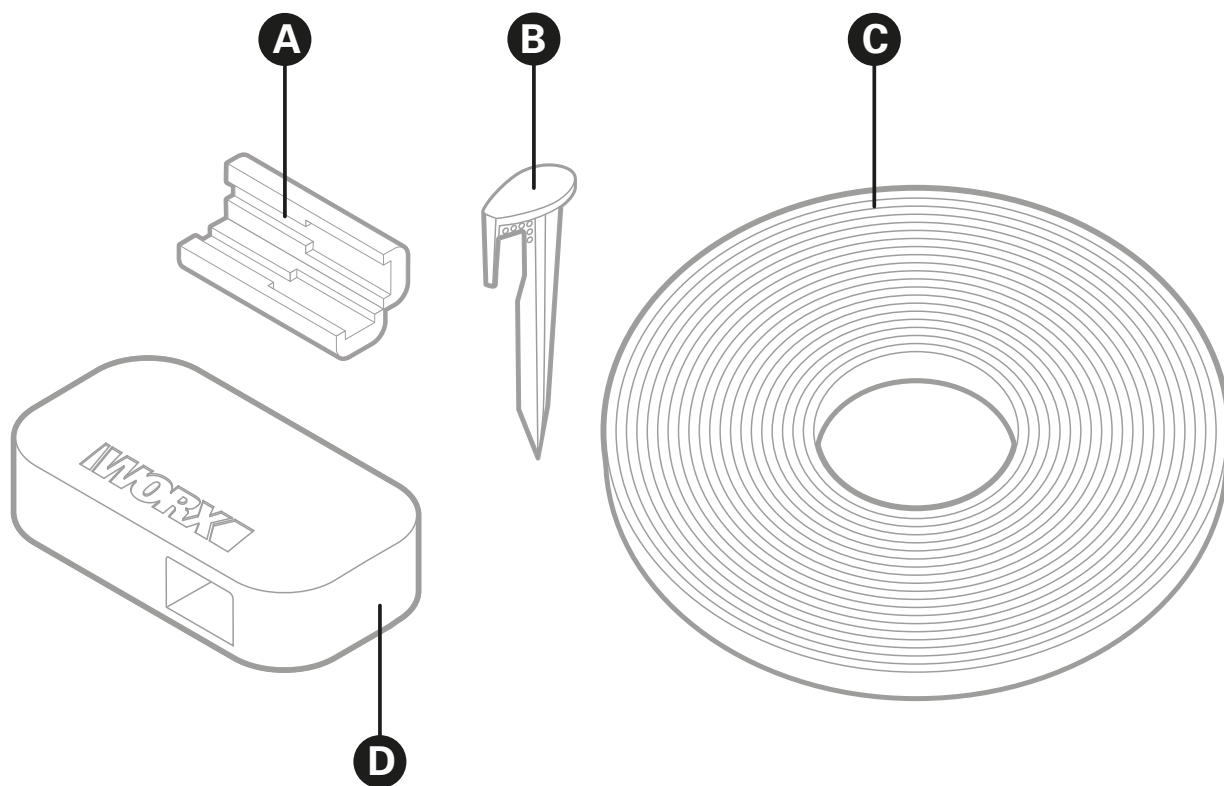

A 8 connectors

B 24 pegs

C 4 magnetic strip coils

D Off Limits module

HOW IT WORKS

The Off Limits option allows you to define a no-mow zone in your lawn without using the boundary wire.

Laying out an island in the middle of the garden, far away from the borders, can often be complicated, and it usually requires a great length of wire. With the Off Limits option you just have to install the magnetic strip around the object you want to exclude from mowing, and you're good to go.

It's particularly useful if you have seasonal equipment like paddling pools or trampolines, or if you've just finished sowing a part of the lawn and you want it to settle before allowing Landroid to mow it. Off Limits is also useful if you decide to change the layout of your garden sometimes after deploying the boundary wire - for example, if you decide to add a flowerbed - so you don't need to redo the whole perimeter.

Off Limits comes in two pieces: a box with a sensor to install on your Landroid and a magnetic strip to surround forbidden areas. The strip does not need to be connected to the perimeter wire, nor to be powered. The sensor detects the magnetic field emitted by the band and bounces away.

Please be advised that the Cut To Edge function won't work around the Off Limits strip.

INSTALLATION

Before proceeding with the installation please make sure your Landroid's firmware is updated to the last version. For more information on firmware upgrade please refer to the "Maintenance" section of the Landroid-o-pedia (<https://support.worx-europe.com>). Follow the steps below according to the Landroid model you own

Landroid S 300 (WR130E) Landroid M 500 (WR141E)

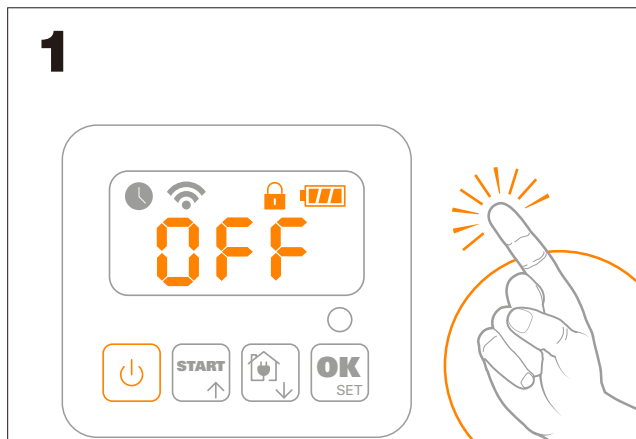

1. Turn off Landroid

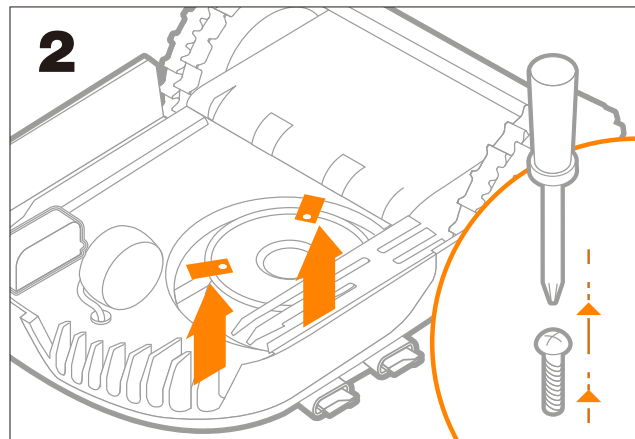

2. Remove Landroid blades using a screwdriver – wear gloves to avoid injury

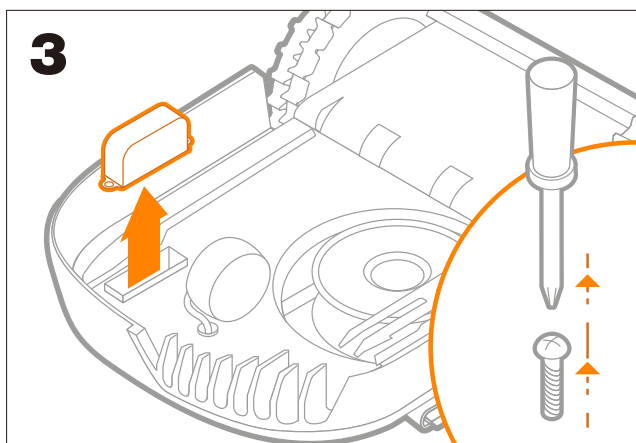

3. Take out the slot cover using a screwdriver



4. Plug the cables of the Off Limits until you hear a "click" and insert the module in its slot

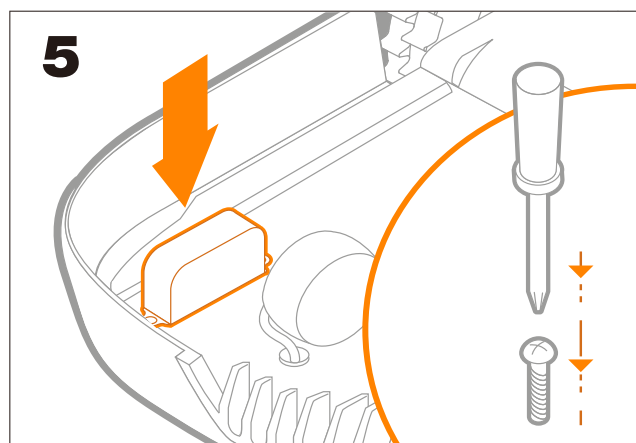

5. Put the cover back and secure it with the included screws.

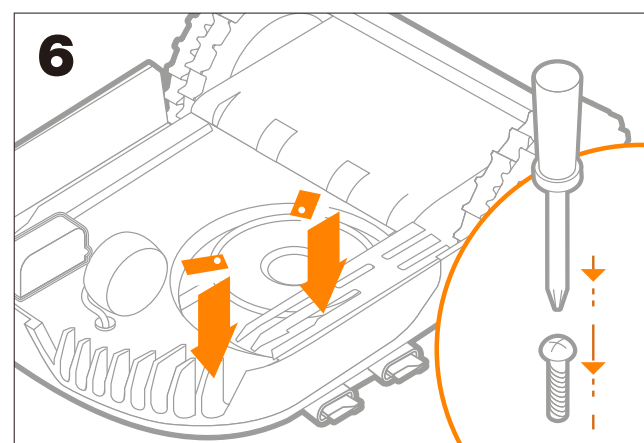

6. Screw Landroid blades back in and turn Landroid on.

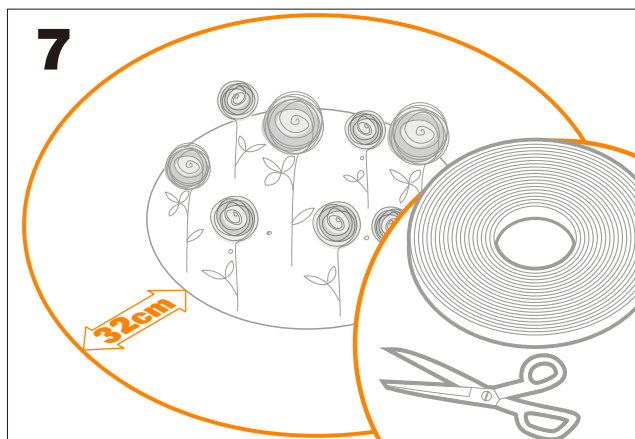

7. Deploy the magnetic strip around the area.
Lay it out at least 32cm away from the area, on its flat side and in a circular or elliptic shape (avoid straight lines and corners).

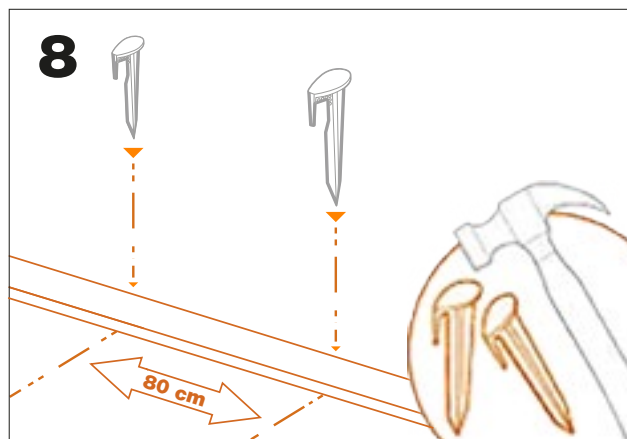

8. Secure it with the provided pegs. The distance between the pegs should be around 80cm.

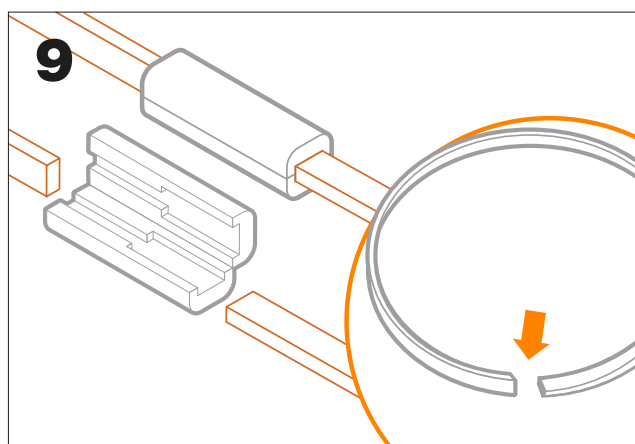

9. Use the connector to close the circuit. The ends of the strip inside the connector need to be at least 2cm long. You can join as many magnetic strips as you want by using the connectors.
There is no size limit.

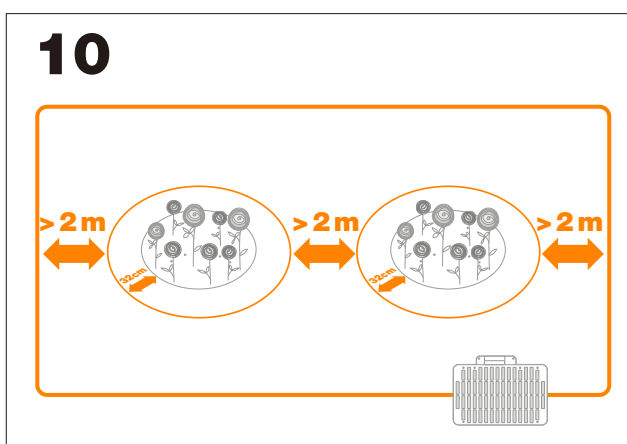

10. The magnetic strip needs to be laid down at least 2 meters away from the boundary wire or another Off Limits area.

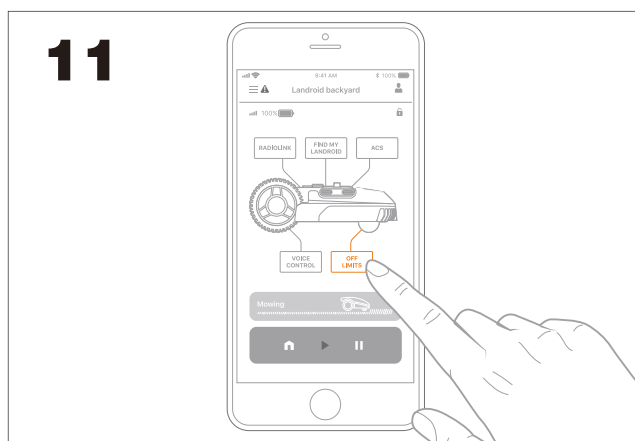

11. The Off Limits icon is now active. Touch it to see the status and to activate/disactivate the option. If the Status shows "error" contact our support team at <https://support.worx-europe.com>



Remember that you can't cross the boundary wire with the magnetic strips!



Avoid lying the magnetic strip in areas where Landroid can slip (eg. areas with slopes).

**Landroid M 700 (WR142E)
Landroid M 1000 (WR143E)**

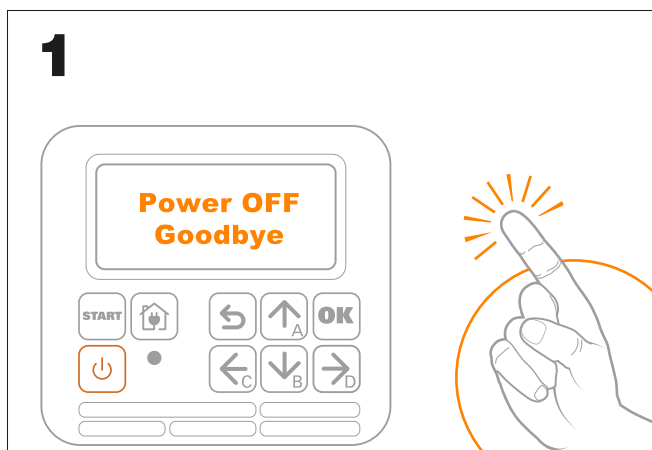

1. Turn off Landroid

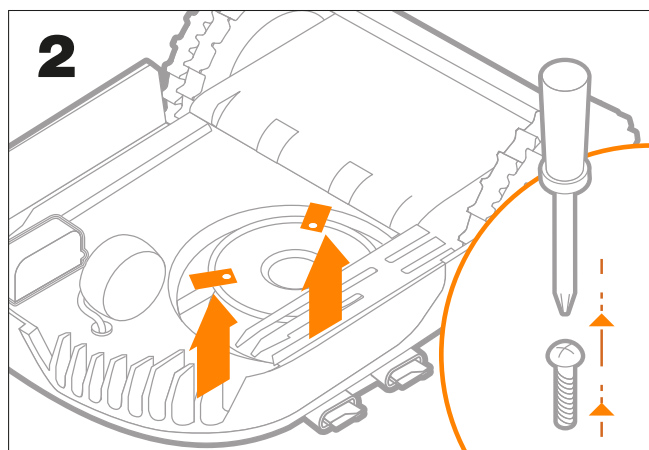

2. Remove Landroid blades using a screwdriver – wear gloves to avoid injury

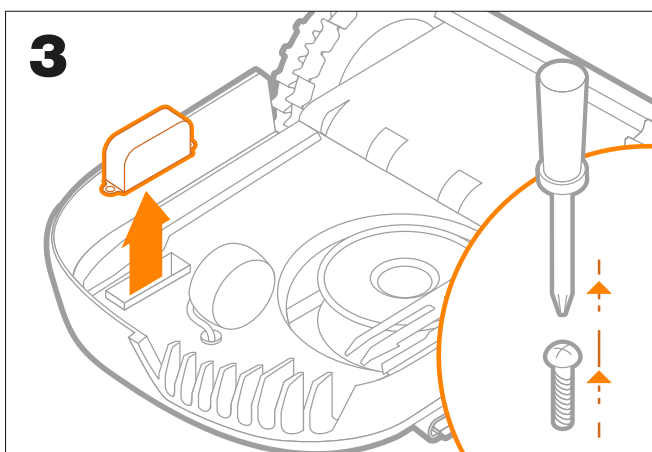

3. Take out the slot cover using a screwdriver

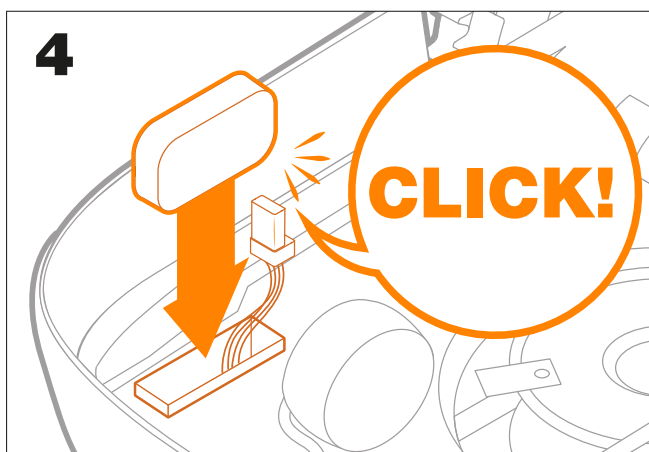

4. Plug the cables of the Off Limits until you hear a “click” and insert the module in its slot

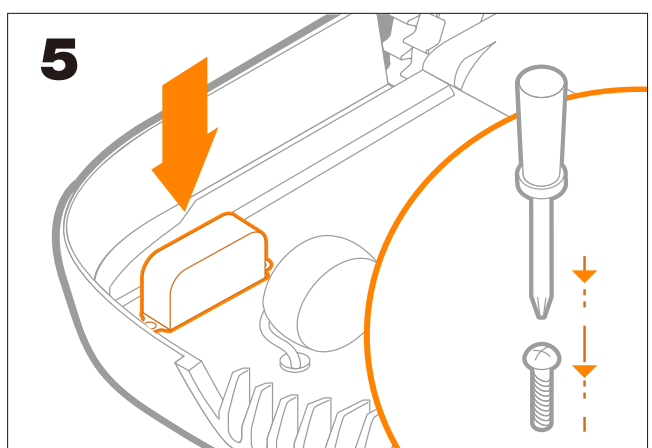

5. Put the cover back and secure it with the included screws.

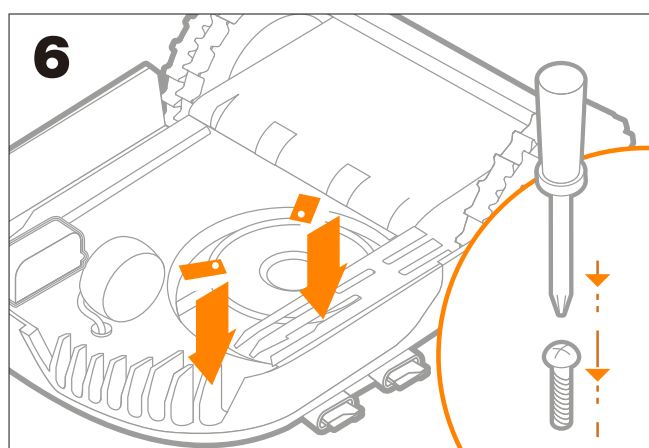

6. Screw Landroid blades back in and turn Landroid on.

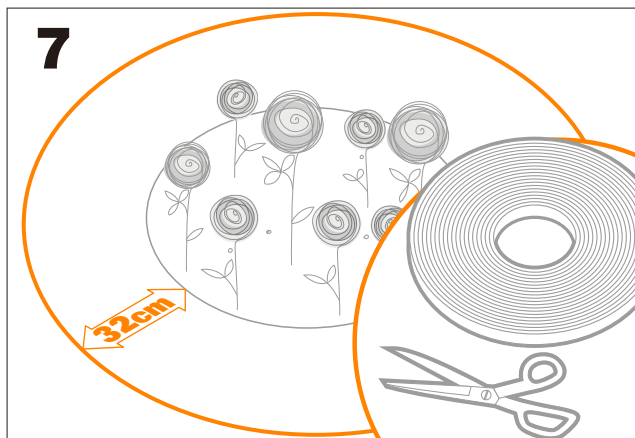

7. Deploy the magnetic strip around the area. Lay it out at least 32cm away from the area, on its flat side and in a circular or elliptic shape (avoid straight lines and corners).

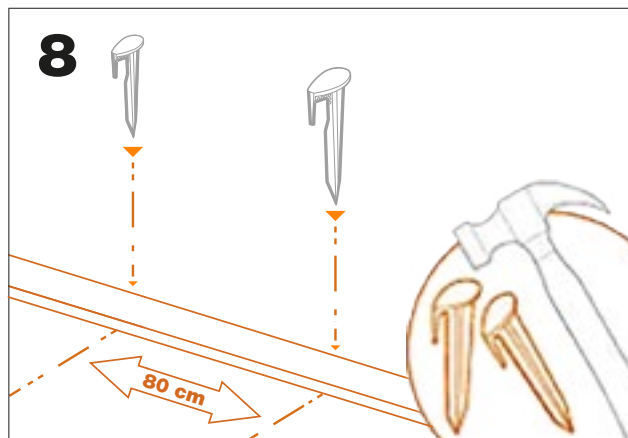

8. Secure it with the provided pegs. The distance between the pegs should be around 80cm.

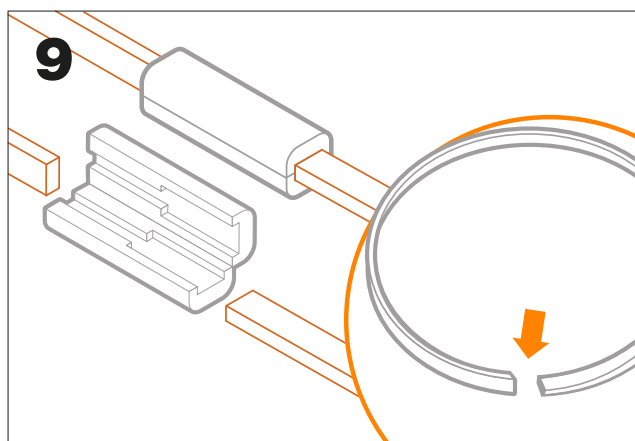

9. Use the connector to close the circuit. The ends of the strip inside the connector need to be at least 2cm long. You can join as many magnetic strips as you want by using the connectors. There is no size limit.

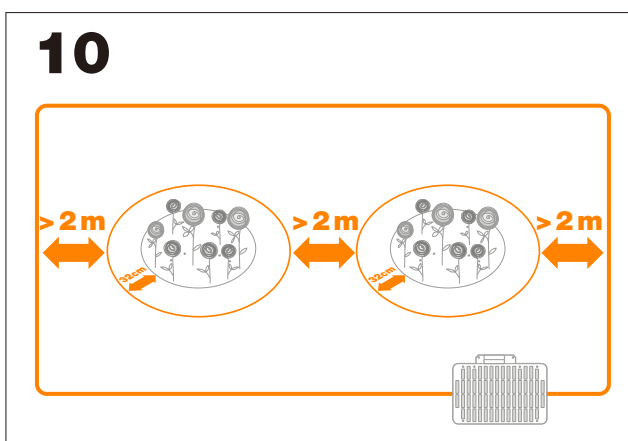

10. The magnetic strip needs to be laid down at least 2 meters away from the boundary wire or another Off Limits area.

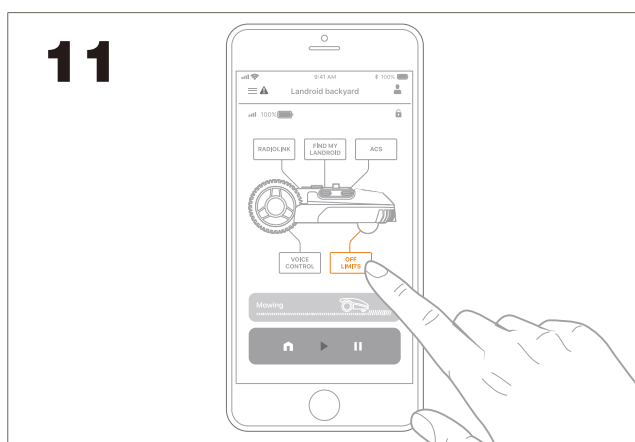

11. The Off Limits icon is now active. Touch it to see the status and to activate/disactivate the option. If the Status shows "error" contact our support team at <https://support.worx-europe.com>



Remember that you can't cross the boundary wire with the magnetic strips!



Avoid lying the magnetic strip in areas where Landroid can slip (eg. areas with slopes).

**Landroid M 500 Plus (WR165E) / Landroid M 700 Plus (WR167E)
Landroid L1000 (WR147E) / Landroid L 1000 (WR147E.1) / Landroid L 800 (WR148E)**

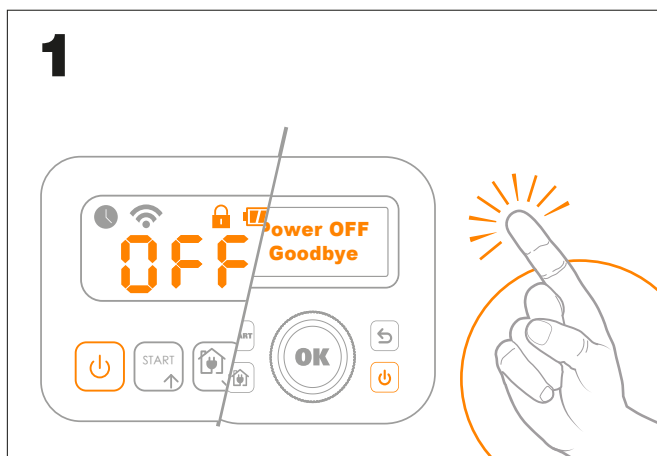

1. Turn off Landroid

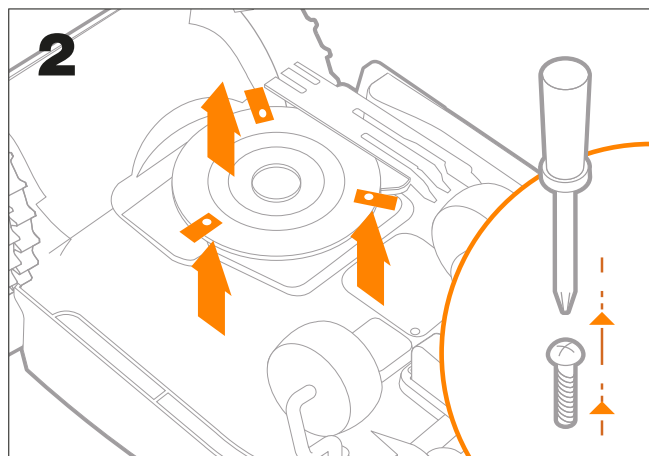

2. Remove Landroid blades using a screwdriver – wear gloves to avoid injury

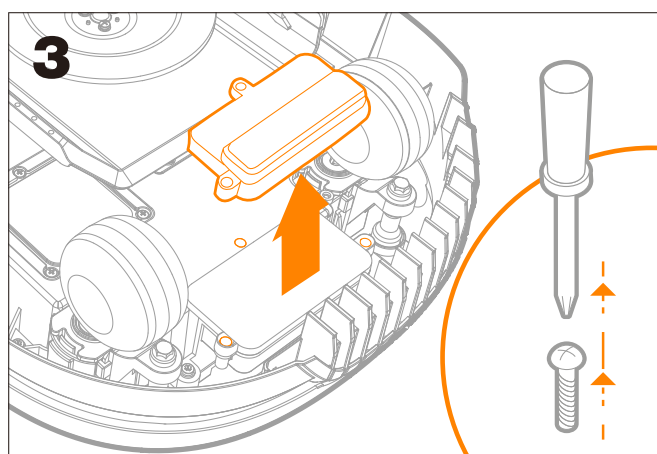

3. Take out the slot cover using a screwdriver

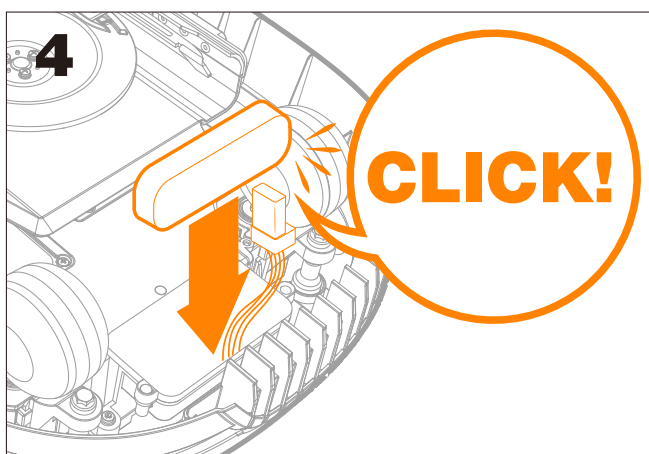

4. Plug the cables of the Off Limits until you hear a “click” and insert the module in its slot

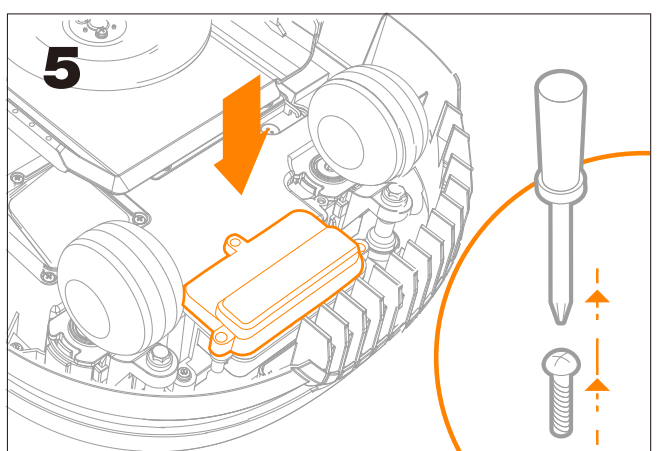

5. Put the cover back and secure it with the included screws.

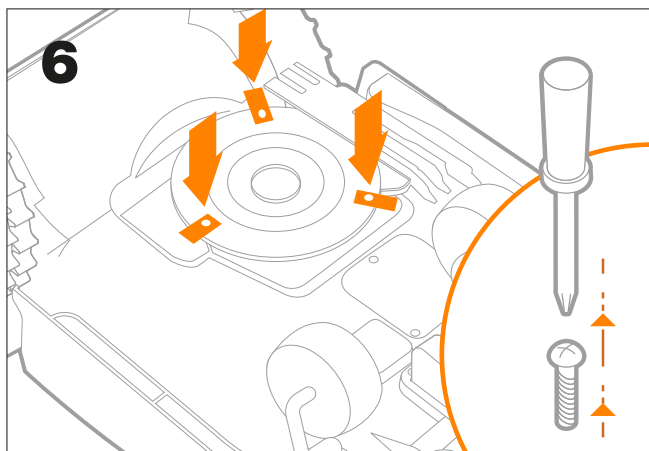

6. Screw Landroid blades back in and turn Landroid on.

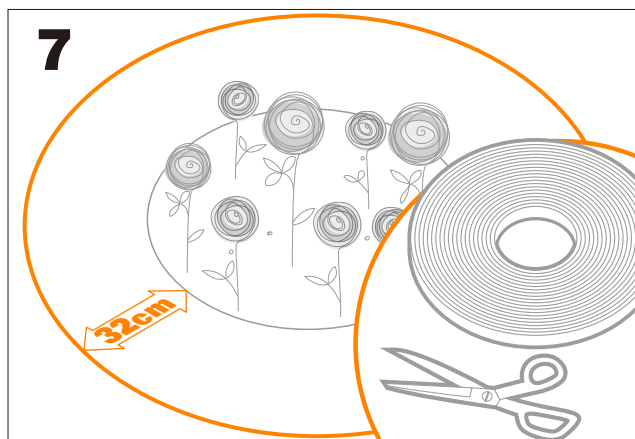

7. Deploy the magnetic strip around the area. Lay it out at least 32cm away from the area, on its flat side and in a circular or elliptic shape (avoid straight lines and corners).

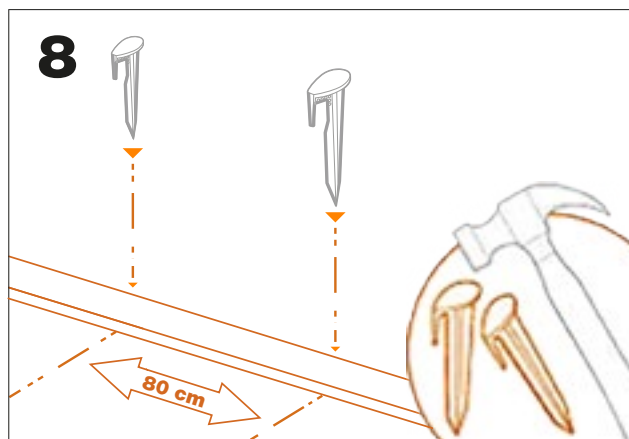

8. Secure it with the provided pegs. The distance between the pegs should be around 80cm.

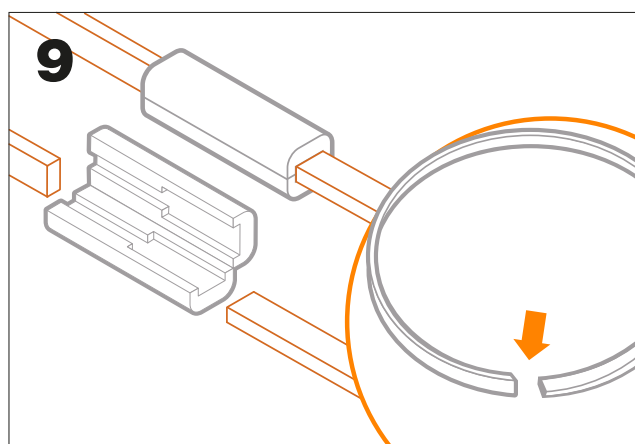

9. Use the connector to close the circuit. The ends of the strip inside the connector need to be at least 2cm long. You can join as many magnetic strips as you want by using the connectors. There is no size limit.

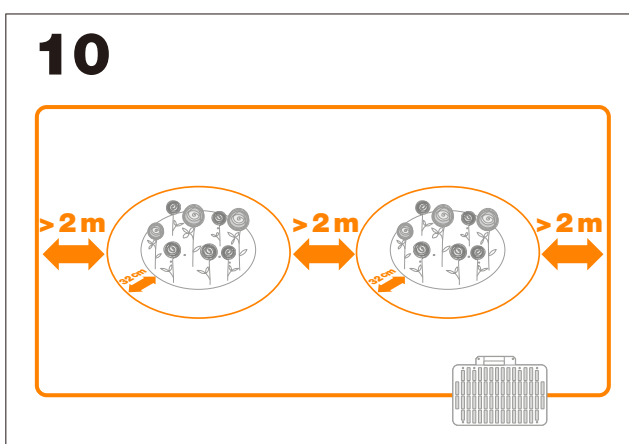

10. The magnetic strip needs to be laid down at least 2 meters away from the boundary wire or another Off Limits area.

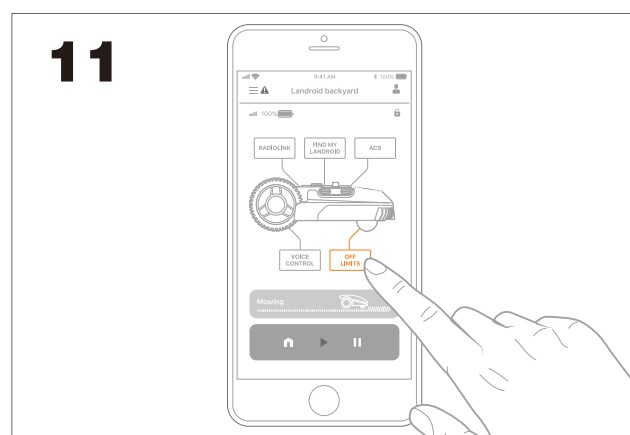

11. The Off Limits icon is now active. Touch it to see the status and to activate/disactivate the option. If the Status shows "error" contact our support team at <https://support.worx-europe.com>



Remember that you can't cross the boundary wire with the magnetic strips!



Avoid lying the magnetic strip in areas where Landroid can slip (eg. areas with slopes).

Landroid L 1500 (WR153E)
Landroid L 2000 (WR155E)

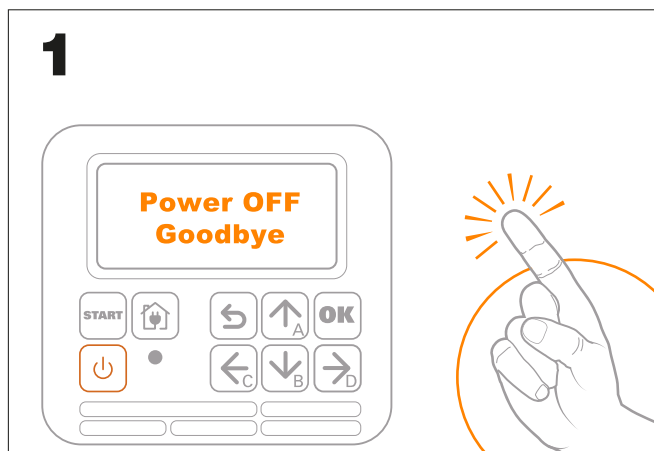

1. Turn off Landroid

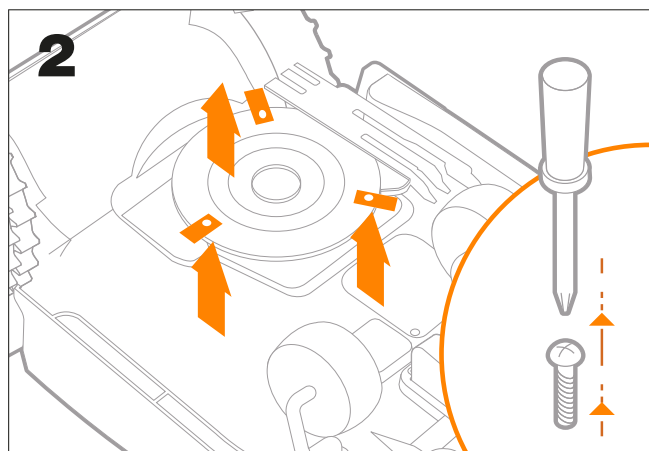

2. Remove Landroid blades using a screwdriver – wear gloves to avoid injury

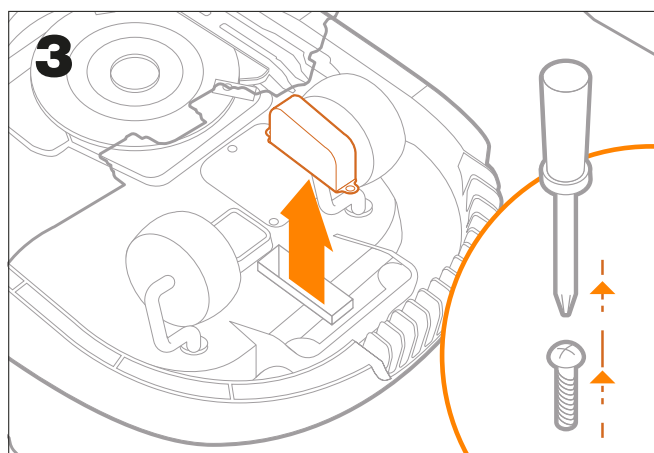

3. Take out the slot cover using a screwdriver

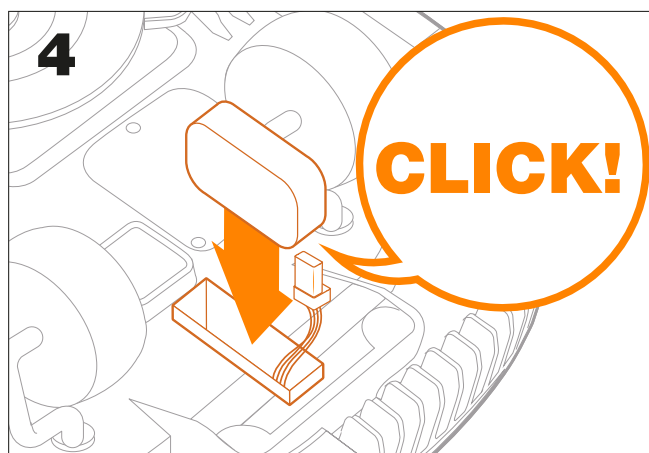

4. Plug the cables of the Off Limits until you hear a “click” and insert the module in its slot

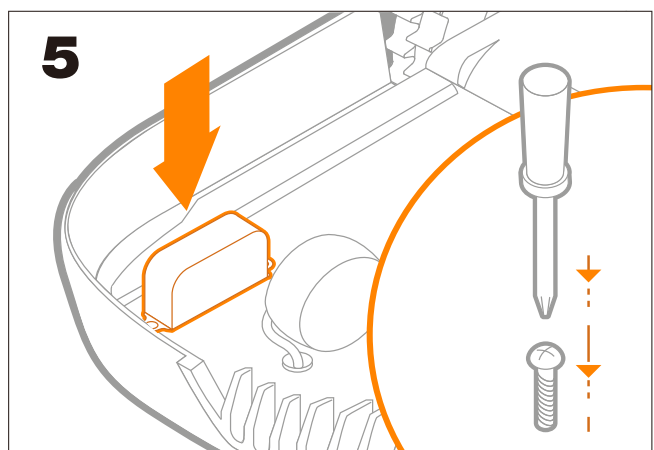

5. Put the cover back and secure it with the included screws.

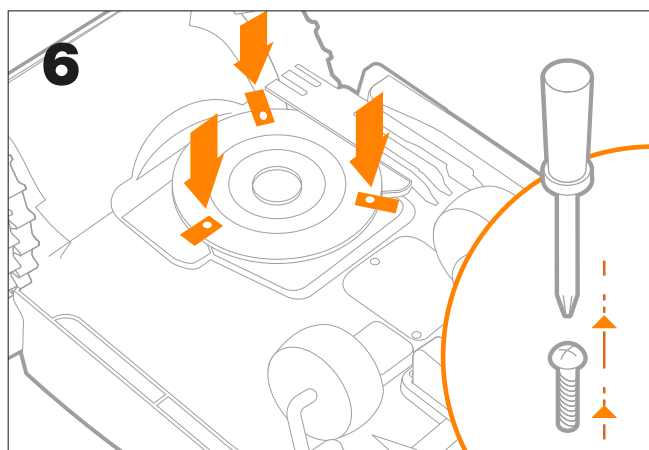

6. Screw Landroid blades back in and turn Landroid on.

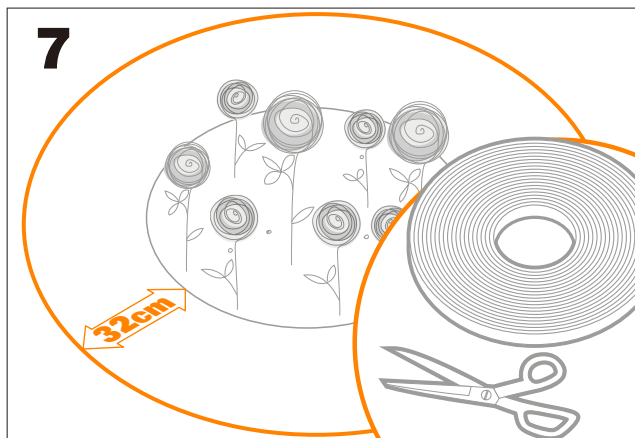

7. Deploy the magnetic strip around the area. Lay it out at least 32cm away from the area, on its flat side and in a circular or elliptic shape (avoid straight lines and corners).

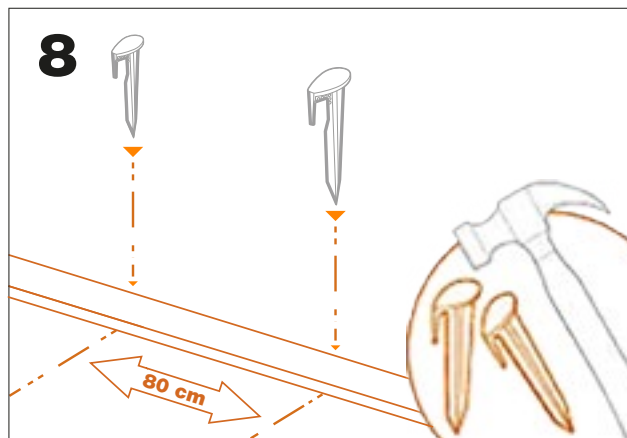

8. Secure it with the provided pegs. The distance between the pegs should be around 80cm.

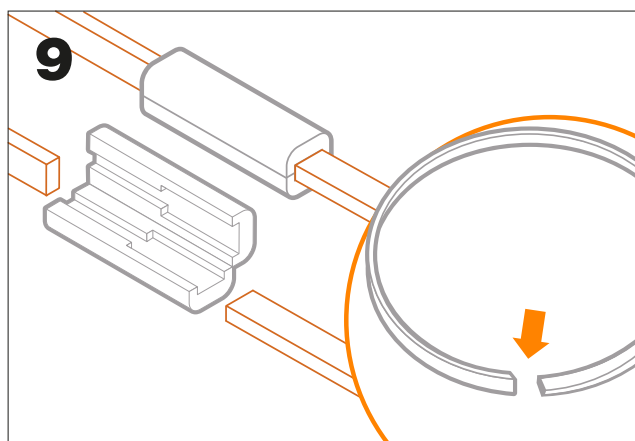

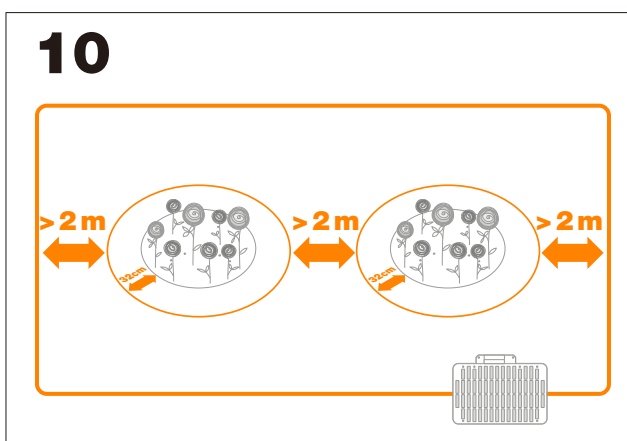

9. Use the connector to close the circuit. The ends of the strip inside the connector need to be at least 2cm long. You can join as many magnetic strips as you want by using the connectors. There is no size limit.

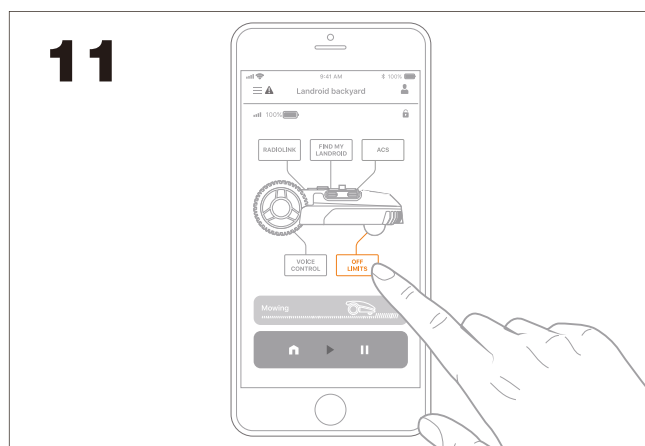

10. The magnetic strip needs to be laid down at least 2 meters away from the boundary wire or another Off Limits area.



11. The Off Limits icon is now active. Touch it to see the status and to activate/disactivate the option. If the Status shows "error" contact our support team at <https://support.worx-europe.com>

-  Remember that you can't cross the boundary wire with the magnetic strips!
-  Avoid lying the magnetic strip in areas where Landroid can slip (eg. areas with slopes).

Troubleshooting

Make sure your Off limits module is securely installed and follow the actions below if your Landroid® does not operate correctly. If these do not identify and correct the problem, please go to <https://account.worxlandroid.com/>, access your profile and open a ticket using the form.

Symptom	Cause	Action
Landroid® fails to recognize the magnetic strip and goes across it.	The magnetic strip loop is not closed.	Every piece of magnetic strip inside the connector should be no shorter than 20mm.
	The connector is not well joined.	Check and make sure the connector is well joined.
	The magnetic strip is buried too deep under ground, in a hole or under the concrete.	Reposition the magnetic strip to lie flat on the ground.
	The magnetic strip is not working as temperature is too high (more than 65°C)	Wait until the temperature cools down.
Landroid® stops near the magnetic strip	Landroid® is trapped after bumping into the magnetic strip several times.	1. Turn Landroid off and take it to an area free of obstacles. 2. Check strip layout. 3. Turn Landroid® on. Press START and OK.
Landroid® runs round near the ring-fence area.	The magnetic strip is too close to the boundary wire. Two ring-fence areas are too close to each other.	Keep a space of at least 2m between the boundary wire and the magnetic strip or between two ring-fence areas.
	The magnetic strip is overlapping the boundary wire.	The magnetic strip should be kept 2m away from the boundary wire.
	Some interference may exist in the working area, due to electric cables or iron pieces underground.	Check and remove interference.
Landroid® enters into the ring-fence area.	Landroid® slips when it draws back and makes a turn after recognizing the magnetic strip.	Avoid lying the magnetic strip in areas where Landroid® can slip (eg. areas with slopes).

Technical data

Rated Voltage	5V
---------------	----

Declaration of Conformity

We,
Positec Germany GmbH
Grüner Weg 10, 50825 Cologne, Germany

Declare that the product
Description **Fence module**
Type **WA0863**
Function **Area isolation**

Complies with the following Directives:
2014/30/EU, 2011/65/EU & (EU)2015/863

Standards conform to
EN 55014-1, EN 55014-2

A handwritten signature in black ink is positioned to the left of the CE mark. The CE mark consists of the letters 'C' and 'E' in a stylized, bold, sans-serif font.

2020/04/08
Allen Ding
Deputy Chief Engineer, Testing & Certification
Positec Technology (China) Co., Ltd.
18, Dongwang Road, Suzhou Industrial
Park, Jiangsu 215123, P. R. China