

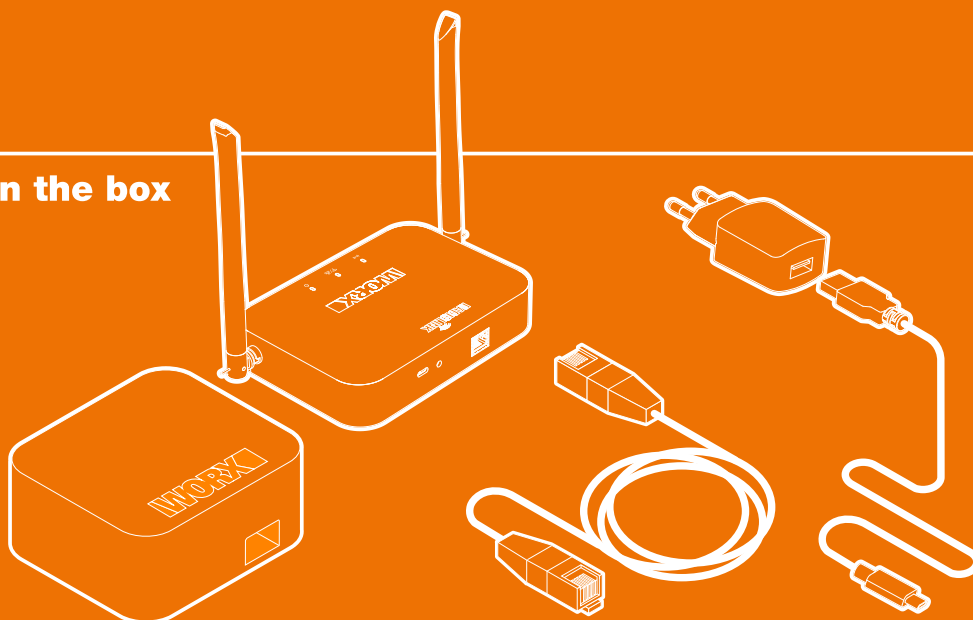

RadioLink  
get started



### In the box



### From your toolbox

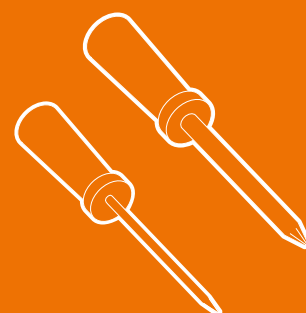

**LANDROID**  
UNMANNED  
MOWING  
VEHICLE

**WA0864**

## TABLE OF CONTENTS

---

### Welcome

p. 03      Contact information

---

### Safety first

p. 05      Important safety instructions

---

### Get familiar with

p. 07      What's in the box

p. 08      How works

---

### Getting started

p. 09      Installation

---

### Quick reference

p. 27      Troubleshooting

p. 28      Technical data

p. 29      Declaration of Conformity

---

**Thank you for purchasing a Worx Landroid RadioLink.**

**We're here to help:**



**Support**

[www.worx-europe.com/support](http://www.worx-europe.com/support)

**Landroid Owner's Site**

<https://account.worxlandroid.com/login>

## IMPORTANT SAFETY INSTRUCTIONS

### RadioLink Gateway and Node - General Safety Warnings



**WARNING: Read all safety warnings and all instructions.**

*Failure to follow the warnings and instructions may result in electric shock, fire and/or serious injury.*

**Carefully read the instructions for the safe operation of the machine.  
Save all warnings and instructions for future reference.**

### RF exposure requirements

To satisfy RF exposure requirements, a separation distance of 200mm or more should be maintained between this device and persons during device operation. Operations at a closer distance are not recommended.

The antenna used for this transmitter must not be co-located in conjunction with any other antenna or transmitter.

### Maintenance

Have your equipment serviced by a qualified repair person using only identical replacement parts. *This will ensure that the safety of the equipment is maintained.*

### Restrictions on putting into service

There are no restrictions of use.

### Symbols



Warning



Read the operator's manual.



Read the operator's manual.



Waste electrical products should not be disposed of with household waste.  
Please recycle where facilities exist.  
Check with your Local Authorities or retailer for recycling advice.





## AC adapter - General Safety Warnings



### **WARNING: Read all safety warnings and all instructions.**

*Failure to follow the warnings and instructions may result in electric shock, fire and/or serious injury.*

### **Save all warnings and instructions for future reference.**

This appliance can be used by children aged from 8 years and above and people with reduced physical, sensory or mental capabilities or lack of experience and knowledge if they have been given supervision or instruction concerning use of the appliance in a safe way and understand the hazards involved. Children shall not play with the appliance. Cleaning and user maintenance shall not be made by children without supervision.

## Additional Safety Warnings

- a. The outlet should be close to the device and be easily accessible.
- b. Do NOT use the device with a damaged cable or case.
- c. Follow the technical data given by the manufacturer if you use the device.
- d. Disconnect the device from the mains when it's not in use.
- e. Do not use the device for a different purpose than that for which it is designed.
- f. Max. ambient temperature 45°C.
- g. The mains connection of this device can't be replaced. If it is broken or damaged, the whole device must be disposed of.
- h. The device must not be exposed to splashing water, rain or humidity.
- i. Vessels containing liquids such as vases should not be put on top of the device.

## Symbols



For indoor use only



Read the operator's manual.



Fuse



Double insulation

**L.P.S**

Low power supply



Waste electrical products should not be disposed of with household waste.  
Please recycle where facilities exist.  
Check with your Local Authorities or retailer for recycling advice.

## **MAINTAIN External power supply WITH CARE**

**Remove the plug from the socket before carrying out any adjustment, servicing or maintenance.**

Your **External power supply** requires no additional lubrication or maintenance. Never use water or chemical cleaners to clean. Wipe clean with a dry cloth. Always store your **External power supply** in a dry place.

## **ENVIRONMENTAL PROTECTION**



Waste electrical products should not be disposed of with household waste.

Please recycle where facilities exist.

Check with your Local Authorities or retailer for recycling advice.

Manufacturer: Mass Power Electronic Limited,  
10/F, TOWER A, BILLION CENTER 1 WANG KWONG ROAD, KOWLOON BAY, KOWLOON, HONG KONG

Importer : Positec Germany GmbH  
Grüner Weg 10, 50825 Cologne, Germany

## WHAT'S IN THE BOX

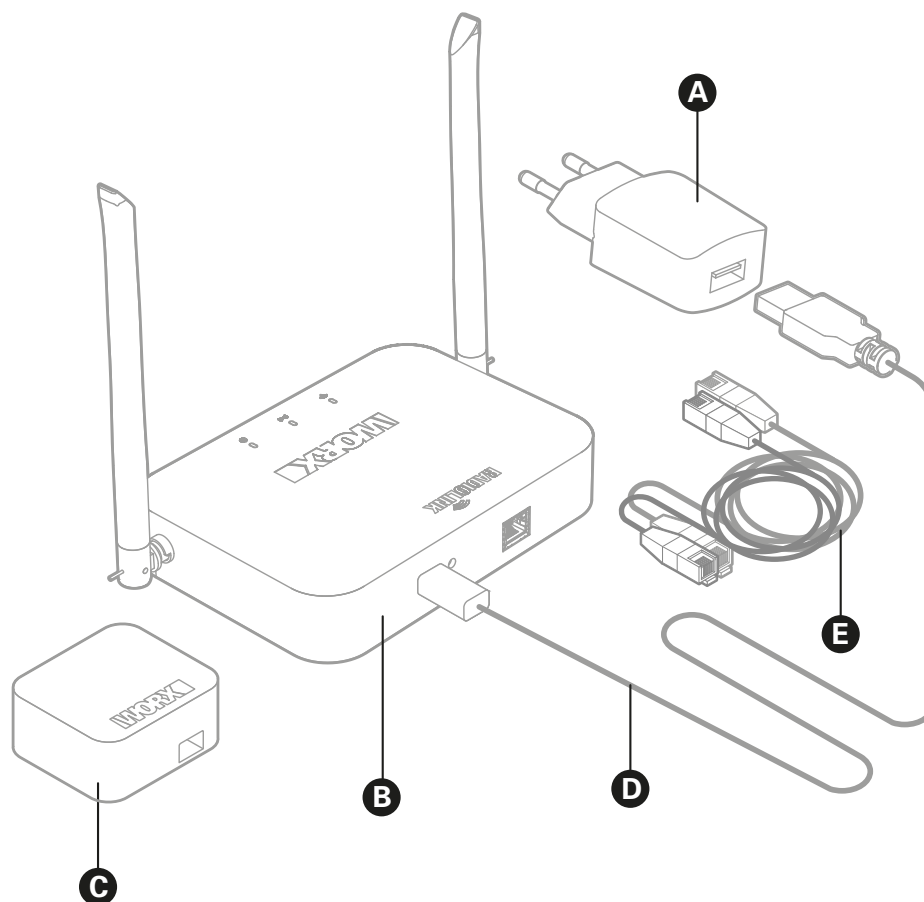

A AC Adapter

B RadioLink Gateway

C RadioLink Module

D Cable

E Ethernet cable

## HOW IT WORKS

The RadioLink option offers constant online connectivity.

Regular domestic Wi-Fi networks typically only cover a fraction of the entire garden—RadioLink instead establishes a radio connectivity that extends it from your Wi-Fi router, regardless of walls, obstacles or interferences.

## INSTALLATION

Before proceeding with the installation please make sure your Landroid's firmware is updated to the last version. For more information on firmware upgrade please refer to the "Maintenance" section of the Landroid-o-pedia (<https://support.worx-europe.com>).

RadioLink comes in two parts and is plug and play. Please follow the steps below depending on Landroid models you own.

### Landroid S 300 (WR130E)

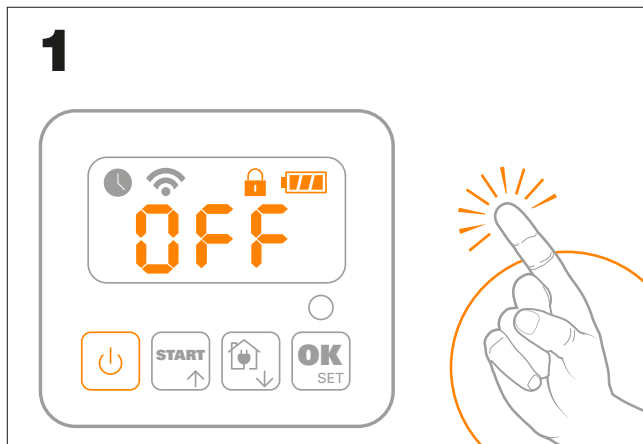

1. Turn off Landroid

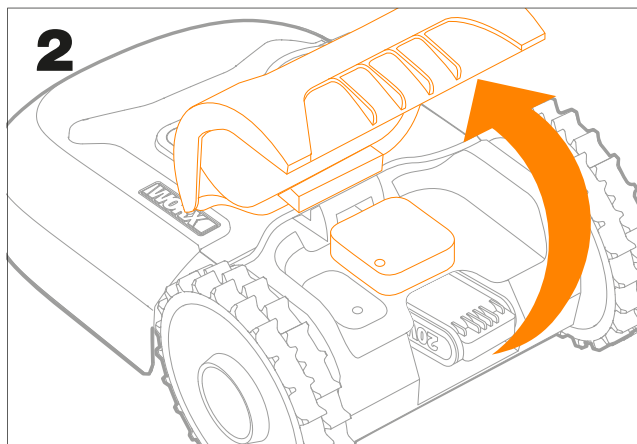

2. Open Landroid's hood

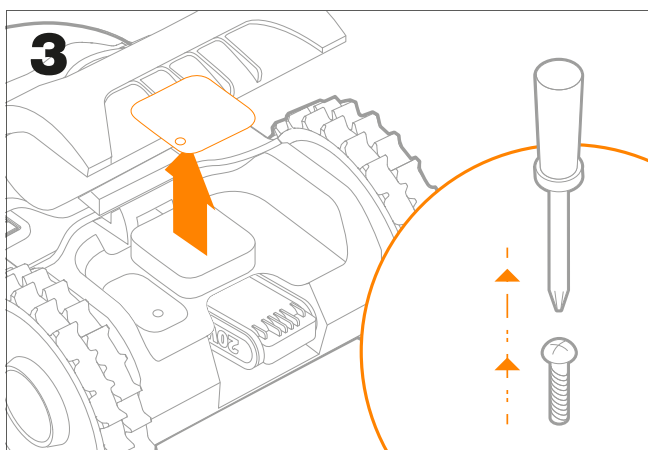

3. Remove the cover using a screwdriver

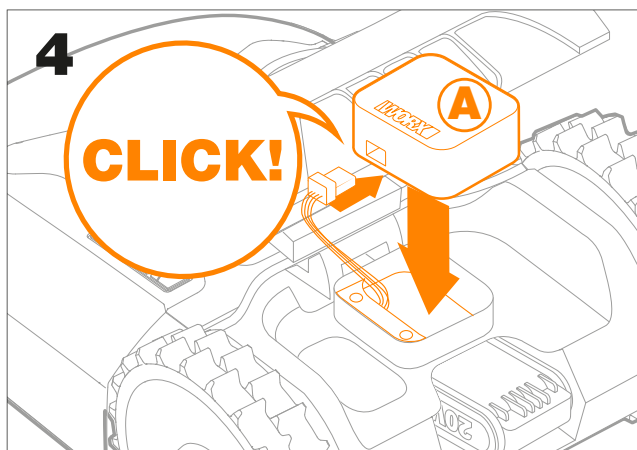

4. Connect RadioLink module to the Landroid's connector till you hear a click and insert it into the slot

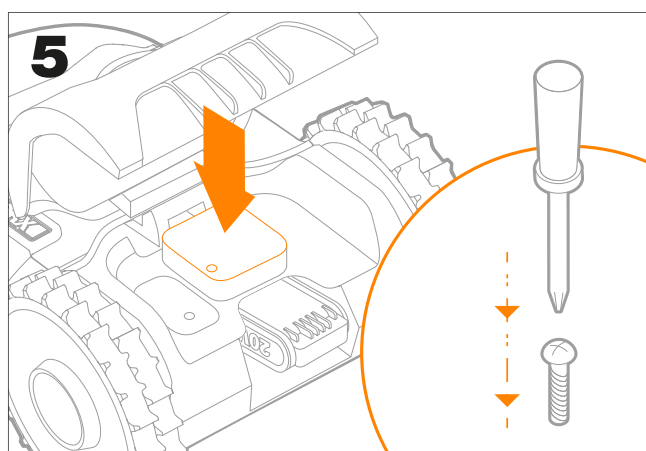

5. Replace the cover using a screwdriver

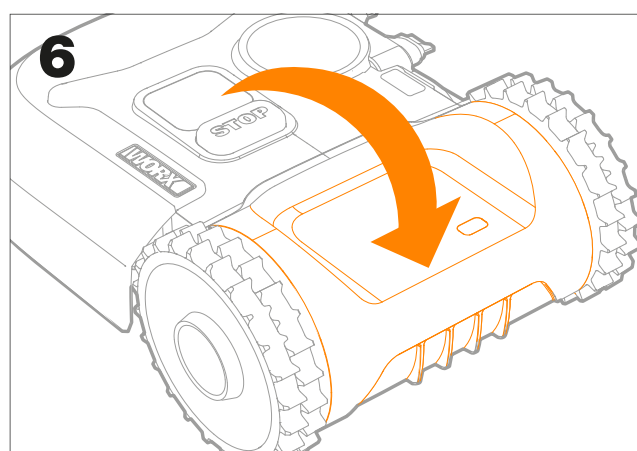

6. Close the hood

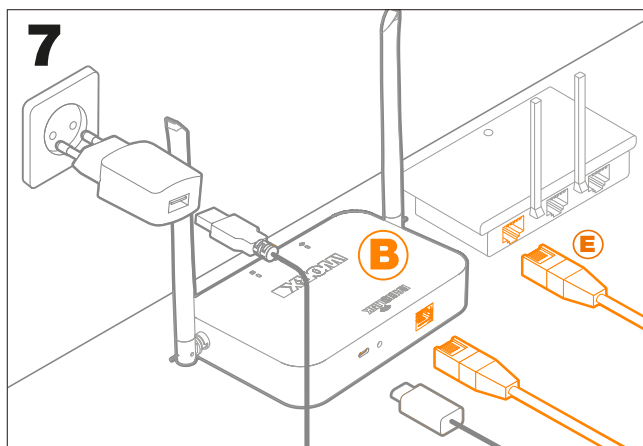

7. Connect the RadioLink Gateway (B) to your router, even if it does not have Wi-Fi, by just connecting the ethernet cable (E)

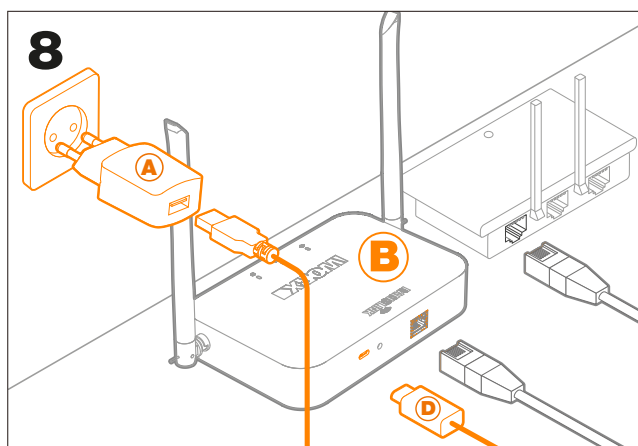

8. Plug the AC adaptor (A) into the main plug and connect it to the RadioLink Gateway (B) by using the cable (D).

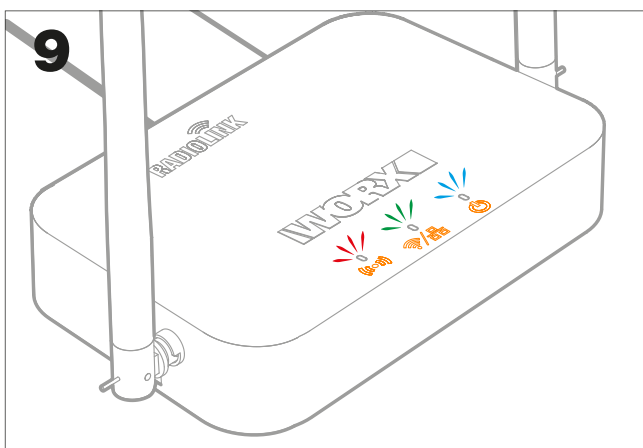

9. The lights will be: UWB (Ultra Wide Band) light is red, Wi-Fi LAN light is green, power light is blue. If not please check trouble shooting guide at the end of this manual.

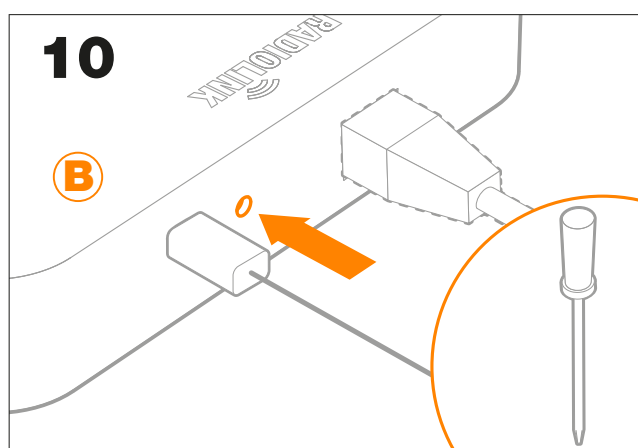

10. Push with a screwdriver in the hole, as per image here above, till you hear a click

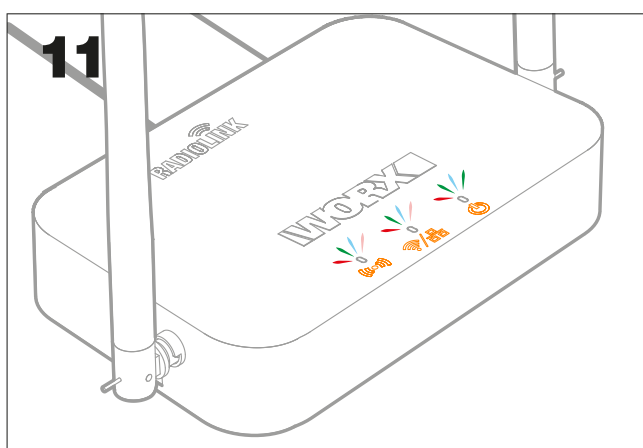

11. The lights will starts blinking multicolor/rainbow

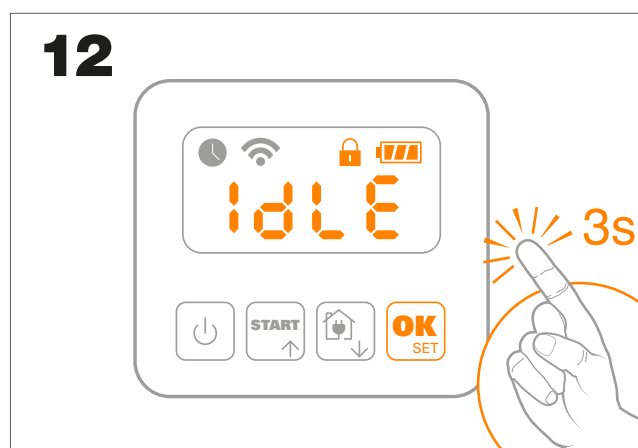

12. Press OK button for 3 seconds

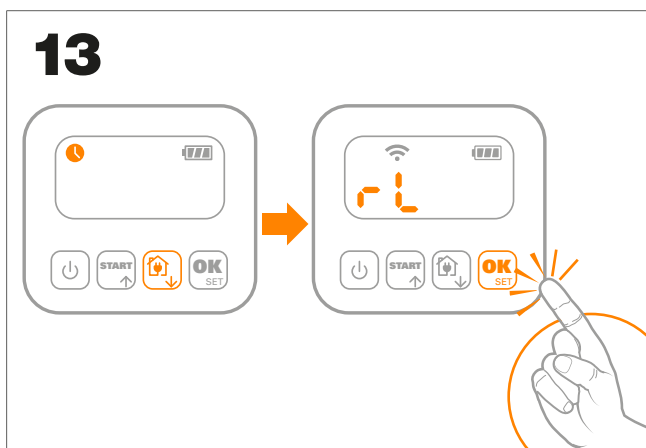

**13.** Press Home and the WI-Fi symbol will appear together with the "rL" wording into the display. Then press OK.



**14.** The display will show "SUcc" if everything is fine.

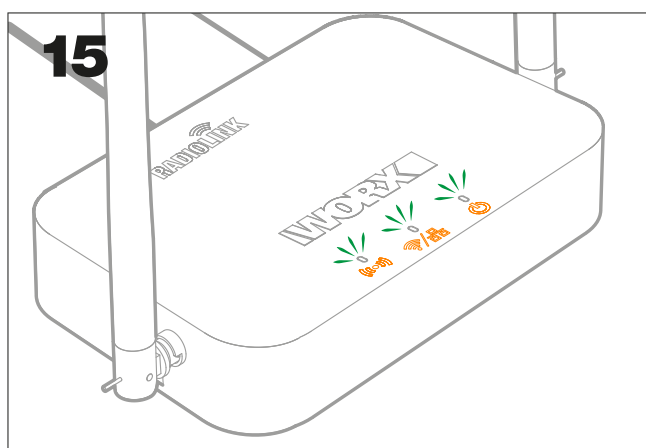

**15.** After a couple of minutes all 3 lights will turn solid green. Please check the trouble shooting section for the different LED colors and their meaning.

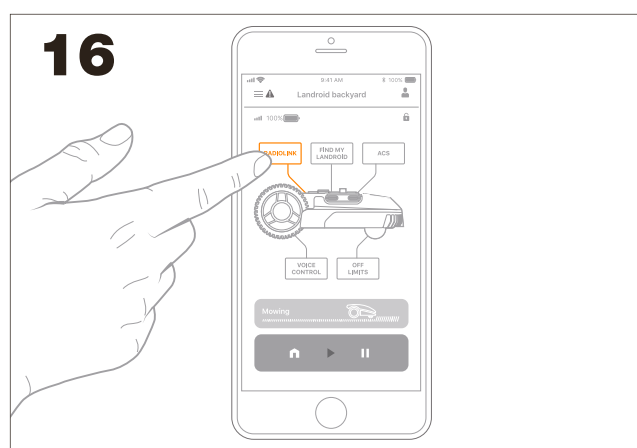

**16.** The Radiolink icon is now active. Touch it to see the status. If the Status shows "error" contact our support team at <https://support.worx-europe.com>

## Landroid M 500 (WR141E)

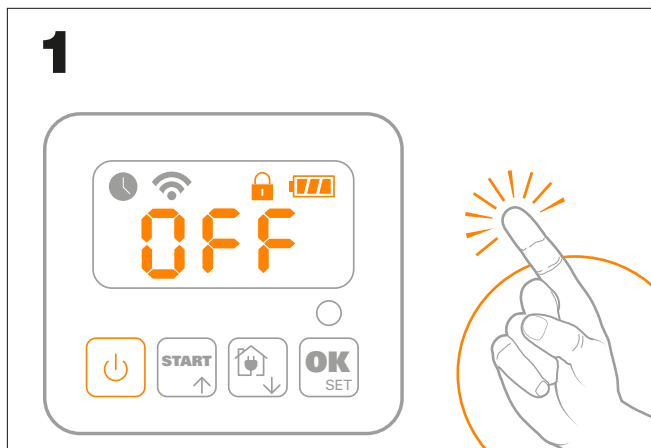

1. Turn off Landroid

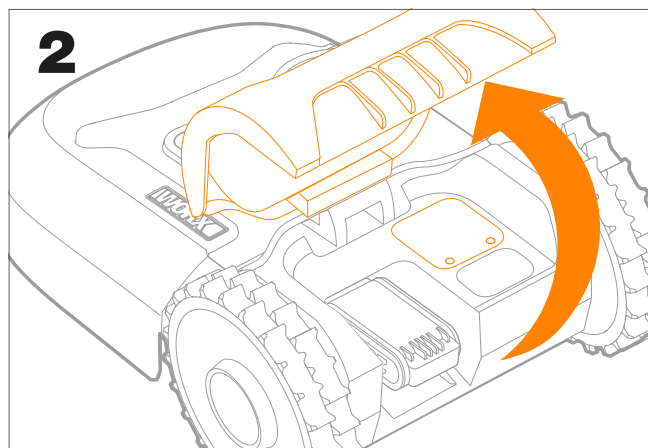

2. Open Landroid's hood

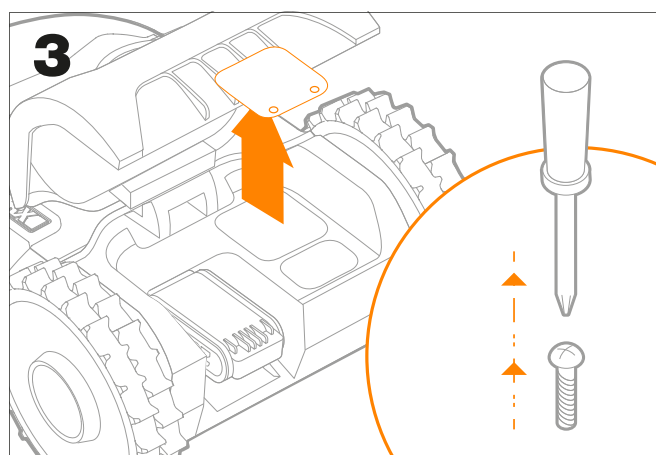

3. Remove the cover using a screwdriver

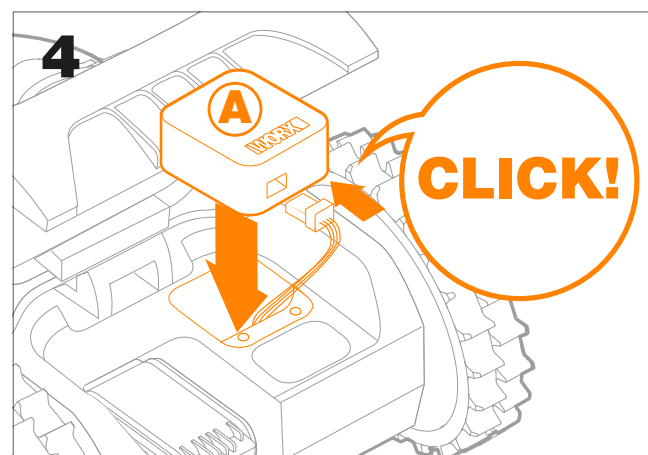

4. Connect RadioLink module to the Landroid's connector till you hear a click and insert it into the slot

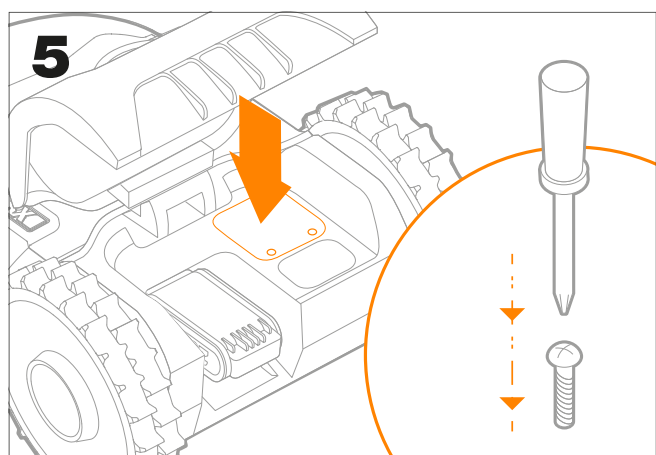

5. Replace the cover using a screwdriver

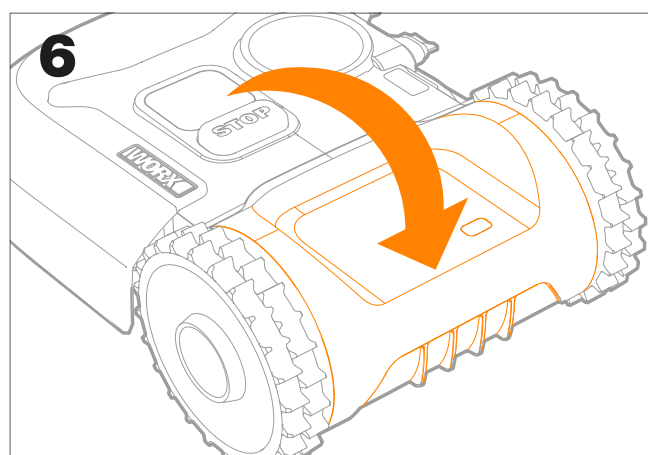

6. Close the hood



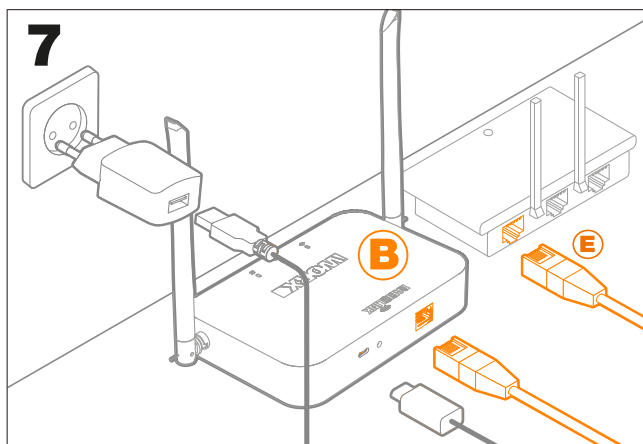

7. Connect the RadioLink Gateway (B) to your router, even if it does not have Wi-Fi, by just connecting the ethernet cable (E)

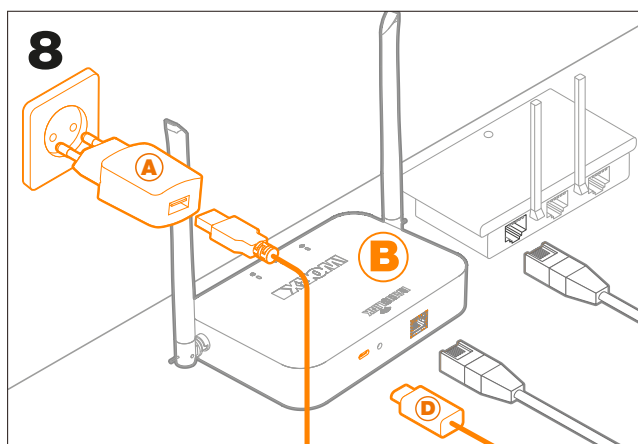

8. Plug the AC adaptor (A) into the main plug and connect it to the RadioLink Gateway (B) by using the cable (D).

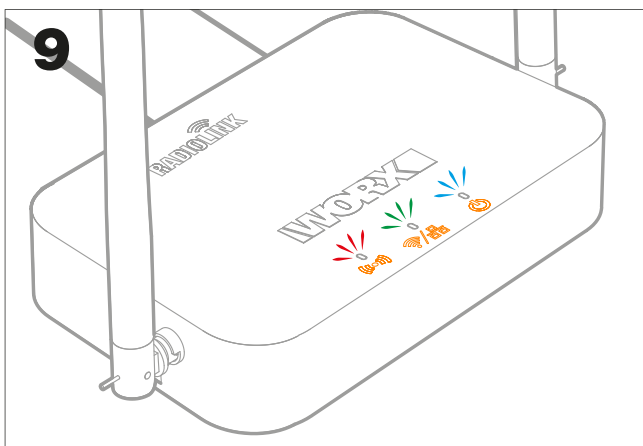

9. The lights will be: UWB (Ultra Wide Band) light is red, Wi-Fi LAN light is green, power light is blue. If not please check trouble shooting guide at the end of this manual.

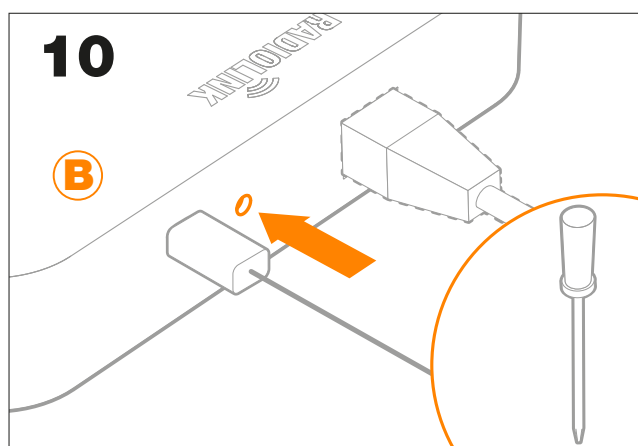

10. Push with a screwdriver in the hole, as per image here above, till you hear a click

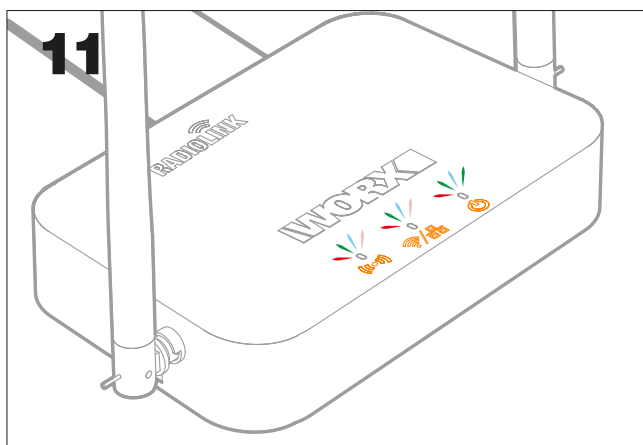

11. The lights will starts blinking multicolor/rainbow

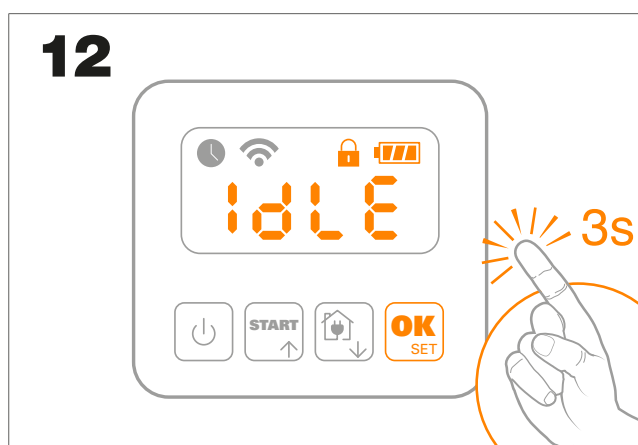

12. Press OK button for 3 seconds

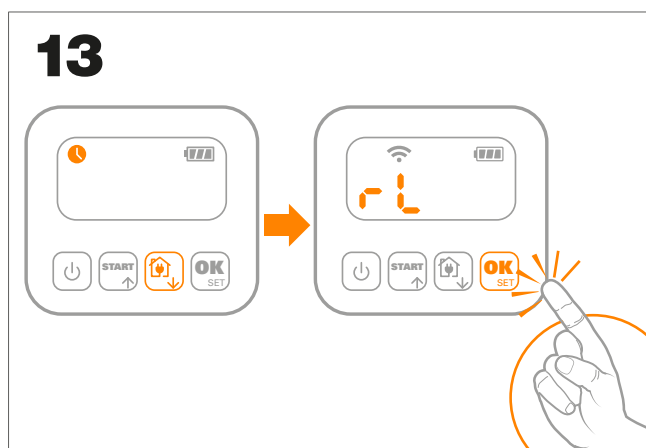

**13.** Press Home and the Wi-Fi symbol  will appear together with the “rL” wording into the display. Then press OK.



**14.** The display will show “SUcc” if everything is fine.

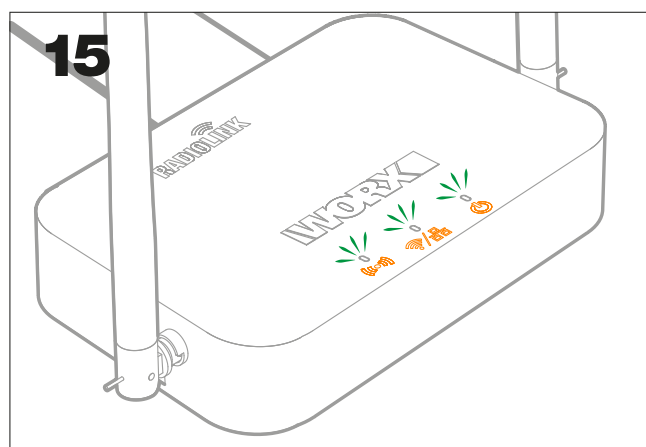

**15.** After a couple of minutes all 3 lights will turn solid green. Please check the trouble shooting section for the different LED colors and their meaning.

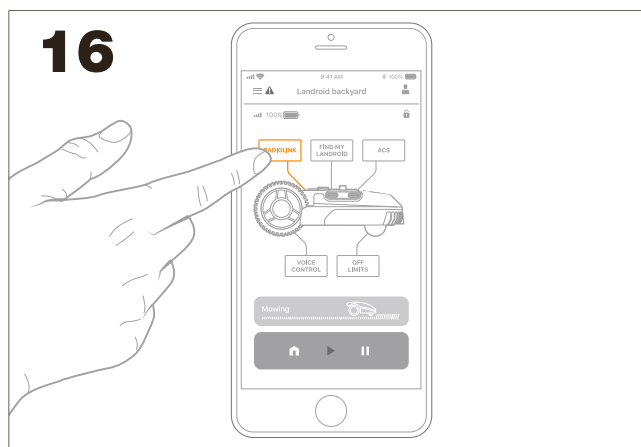

**16.** The RadioLink icon is now active. Touch it to see the status. If the Status shows “error” contact our support team at <https://support.worx-europe.com>

**Landroid M 700 (WR1421E)**  
**Landroid M 1000 (WR143E)**

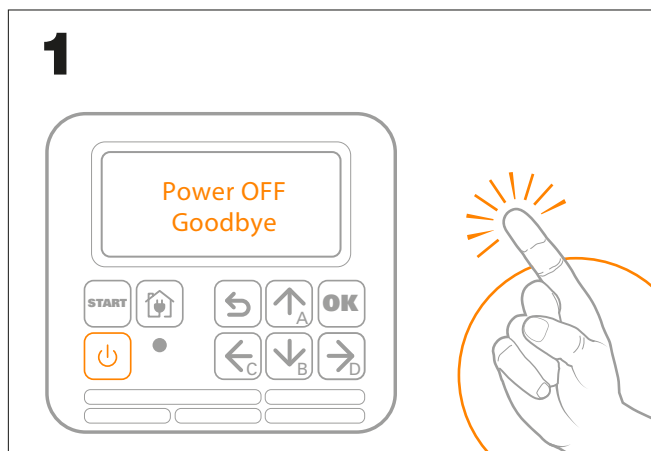

1. Turn off Landroid

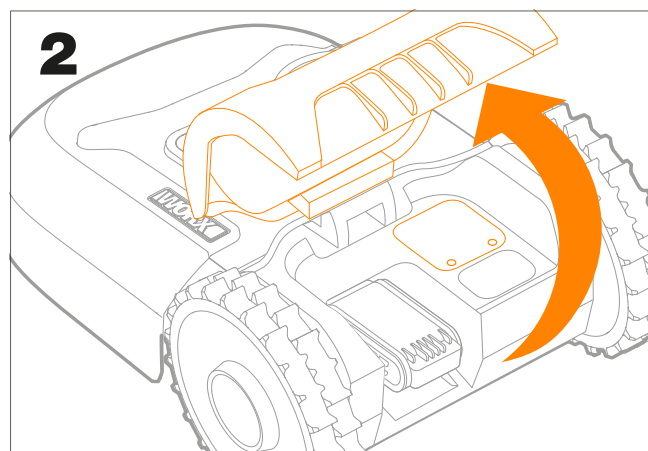

2. Open Landroid's hood

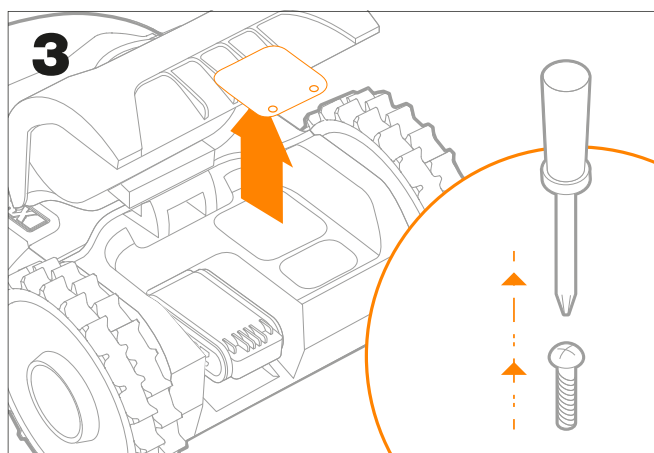

3. Remove the cover using a screwdriver

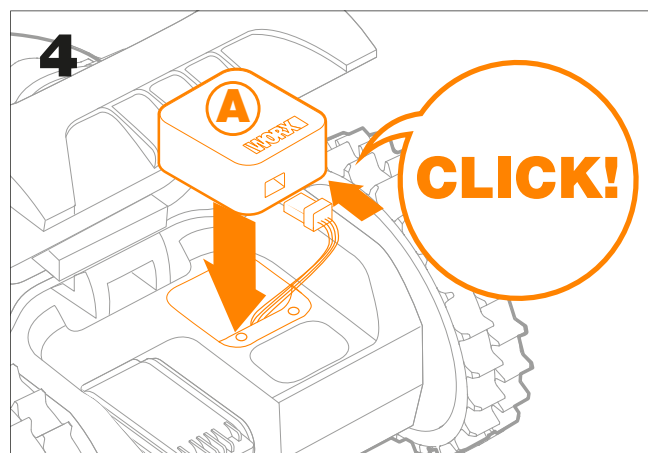

4. Connect RadioLink module to the Landroid's connector till you hear a click and insert it into the slot

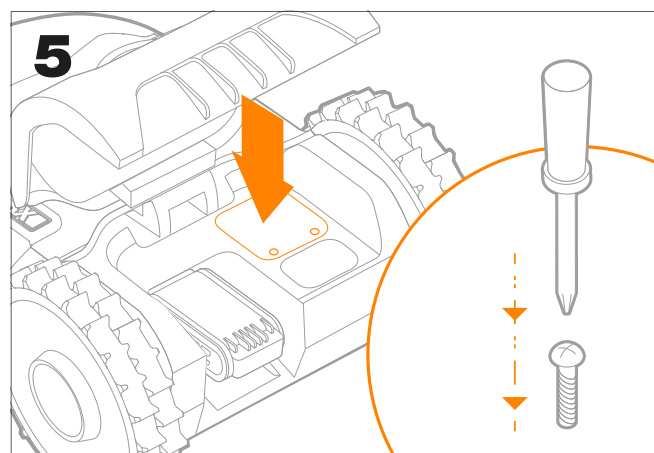

5. Replace the cover using a screwdriver

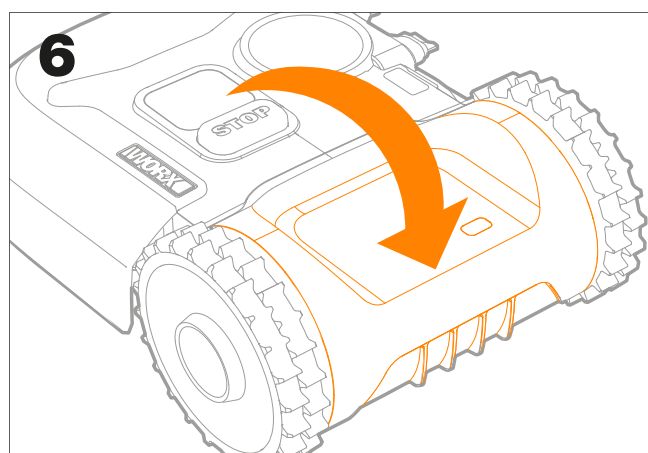

6. Close the hood

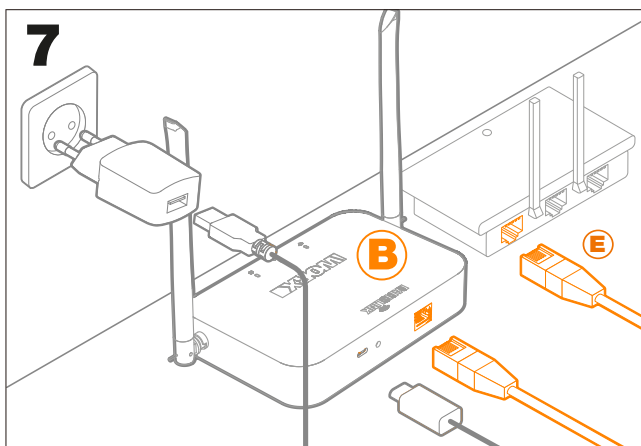

7. Connect the RadiLink Gateway (B) to your router, even if it does not have Wi-Fi, by just connecting the ethernet cable (E)

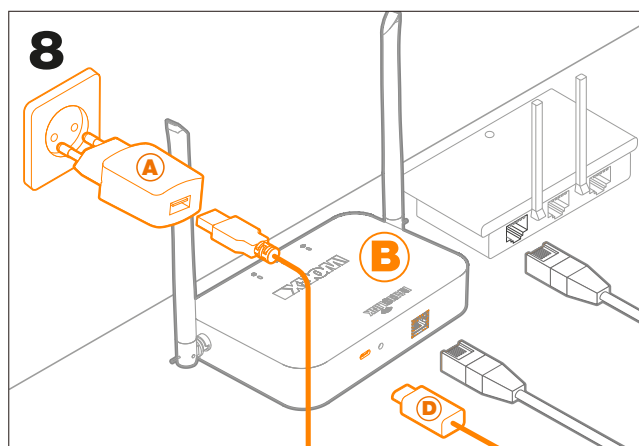

8. Plug the AC adaptor (A) into the main plug and connect it to the RadiLink Gateway (B) by using the cable (D).

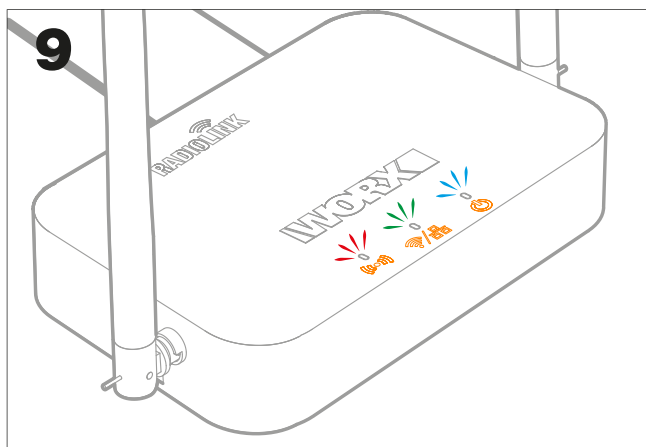

9. The lights will be: UWB (Ultra Wide Band) light is red, Wi-Fi LAN light is green, power light is blue. If not please check trouble shooting guide at the end of this manual.

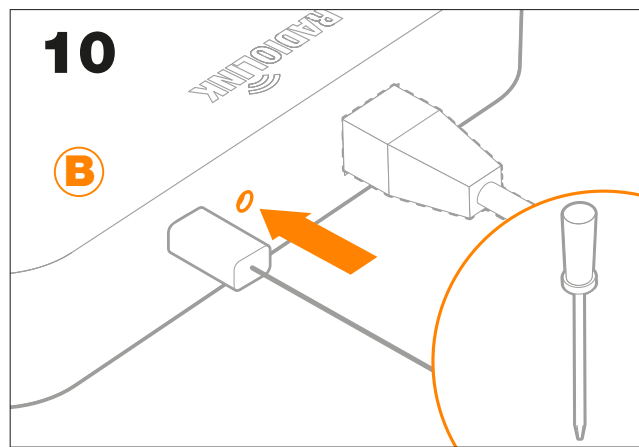

10. Push with a screwdriver in the hole, as per image here above, till you hear a click

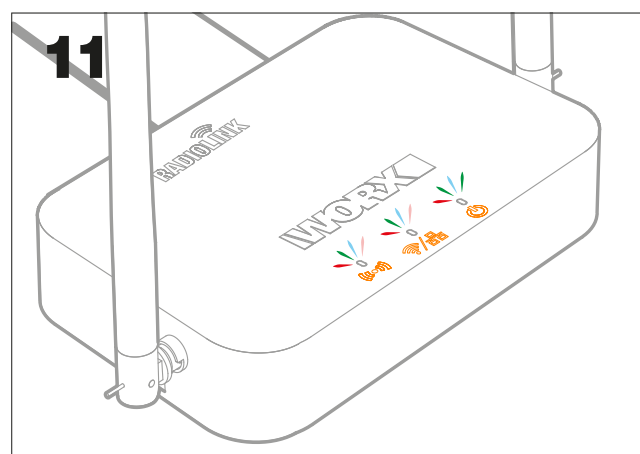

11. The lights will starts blinking multicolor/rainbow



12. Select "General setting"  from the display menu and press OK



**13.** Choose “Select RadioLink” by using the arrow and press OK



**14.** The wording “Press OK to start pairing RadioLink – Gateway” will appear, press OK



**15.** The message “Pairing successful!” will appear on display

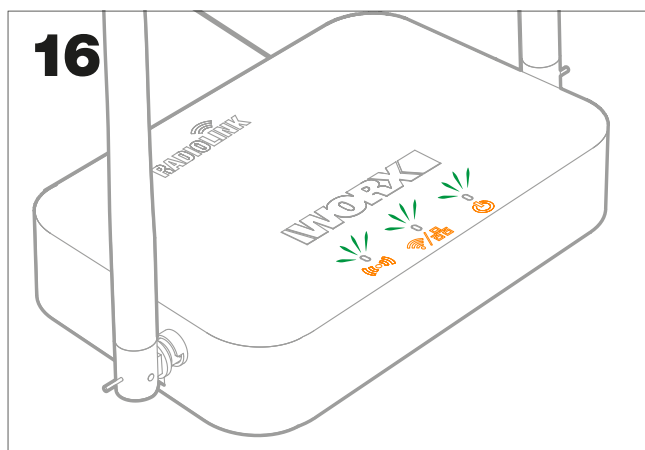

**16.** After a couple of minutes all 3 lights will turn solid green. Please check the trouble shooting section for the different LED colors and their meaning.

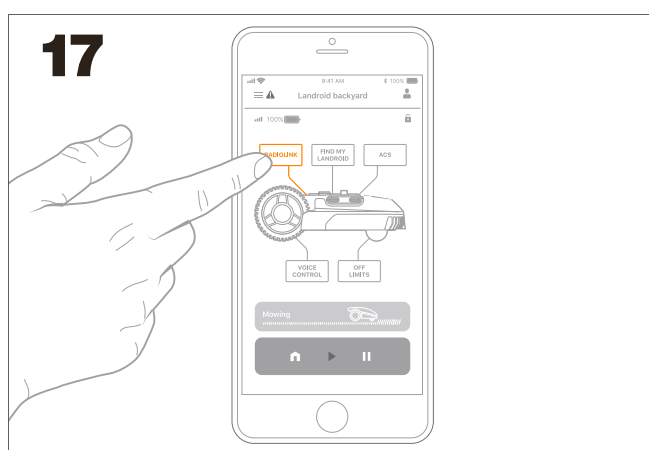

**17.** The RadioLink icon is now active. Touch it to see the status.  
If the Status shows “error” contact our support team at <https://support.worx-europe.com>

## Landroid L 1000 (WR147E)

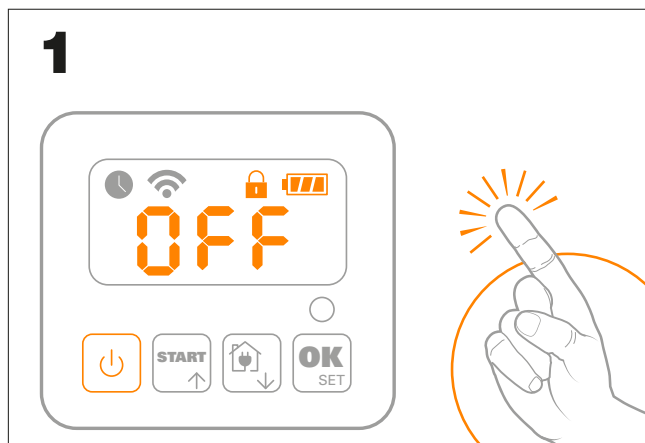

1. Turn off Landroid

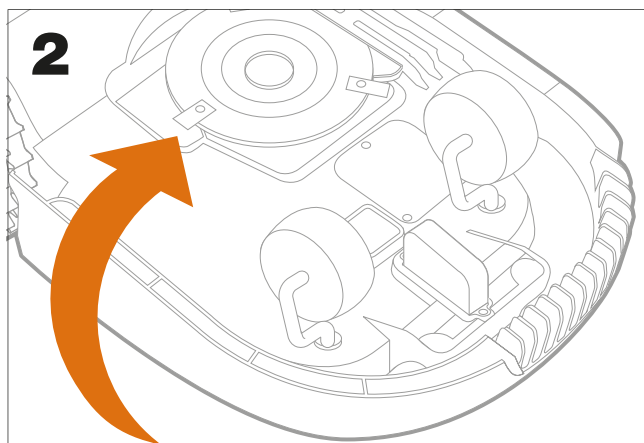

2. Turn Landroid upside down

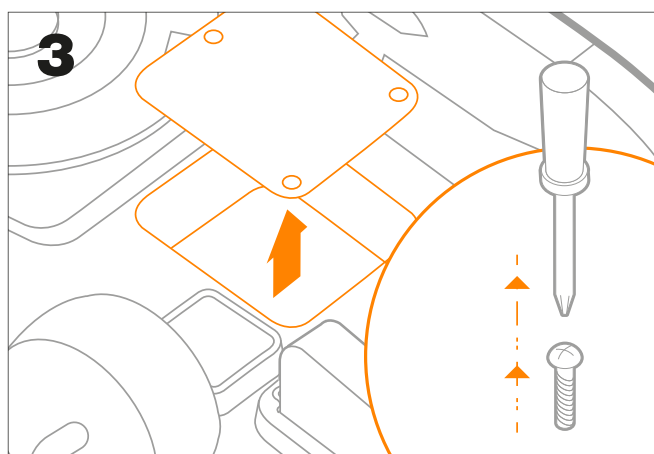

3. Remove the cover using a screwdriver

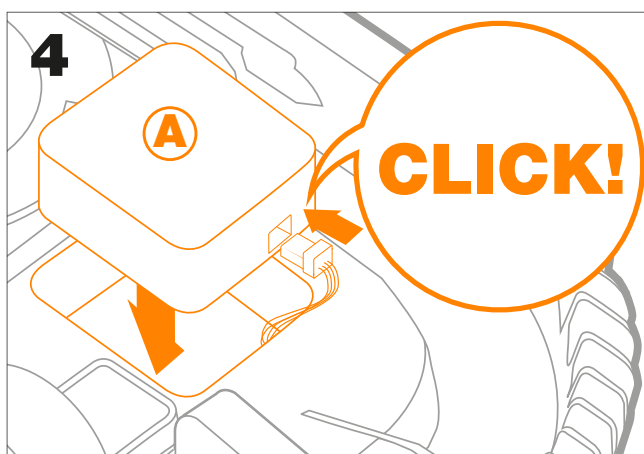

4. Connect RadiLink module to the Landroid's connector till you hear a click and insert it into the slot

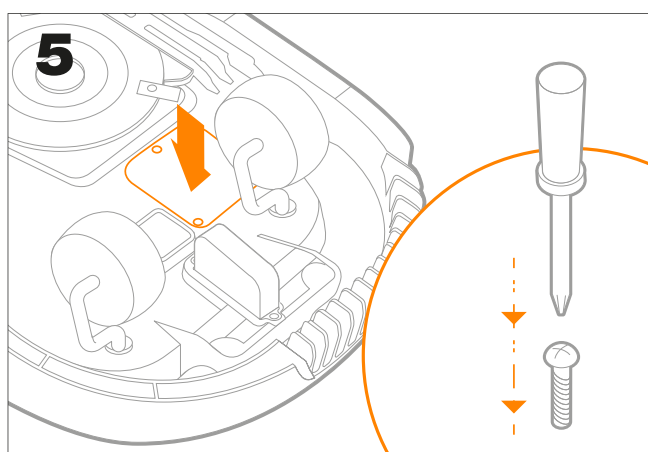

5. Replace the cover using a screwdriver

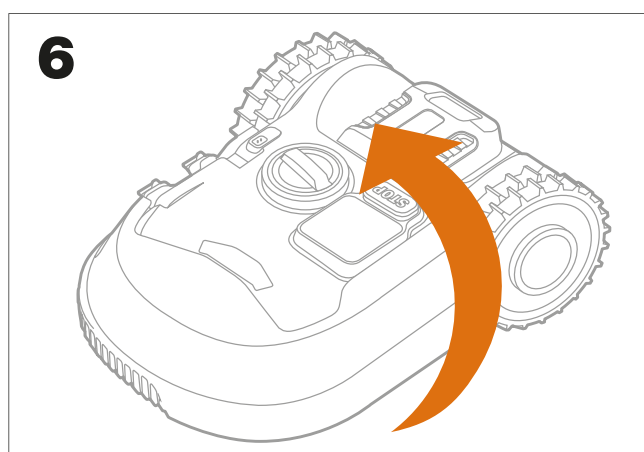

6. Replace Landroid to its position

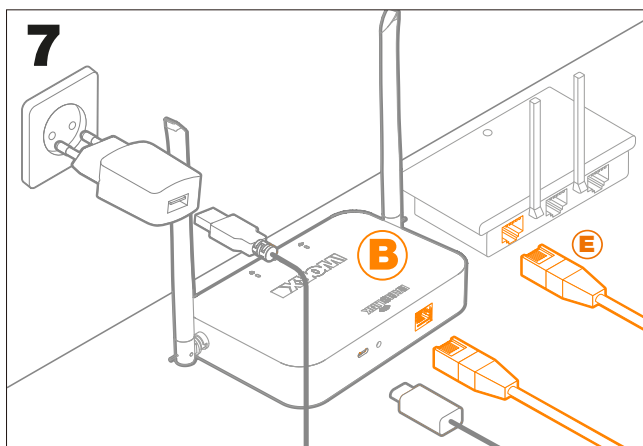

7. Connect the RadioLink Gateway (B) to your router, even if it does not have Wi-Fi, by just connecting the ethernet cable (E)

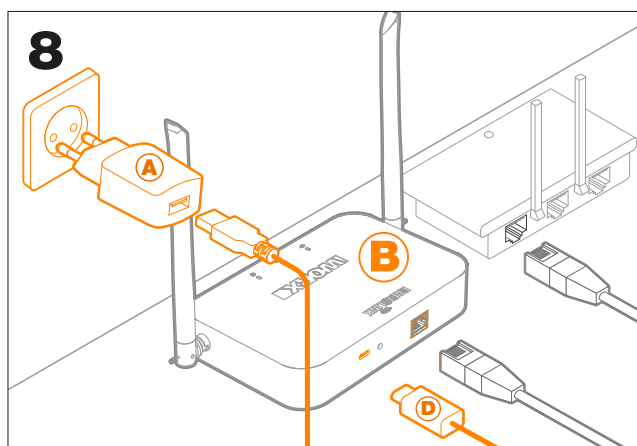

8. Plug the AC adaptor (A) into the main plug and connect it to the RadioLink Gateway (B) by using the cable (D).

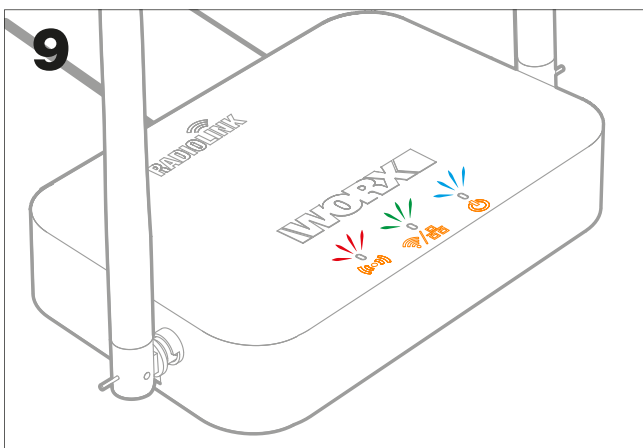

9. The lights will be: UWB (Ultra Wide Band) light is red, Wi-Fi LAN light is green, power light is blue. If not please check trouble shooting guide at the end of this manual.

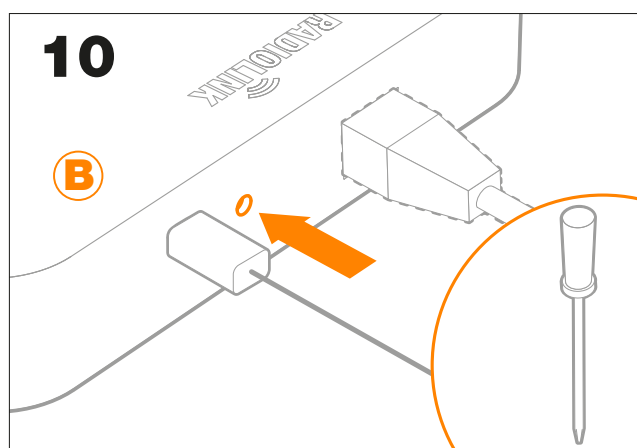

10. Push with a screwdriver in the hole, as per image here above, till you hear a click

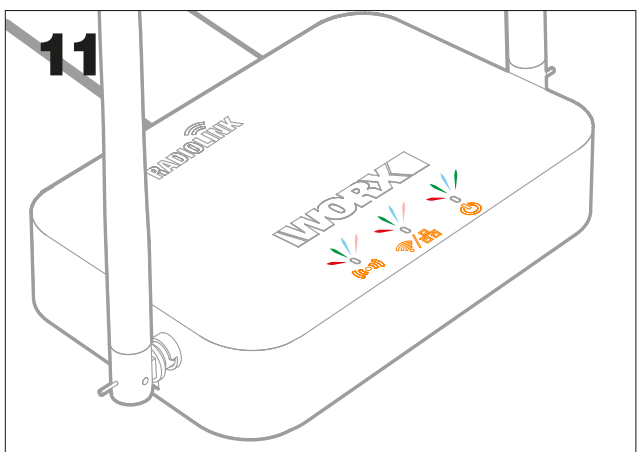

11. The lights will starts blinking multicolor/rainbow

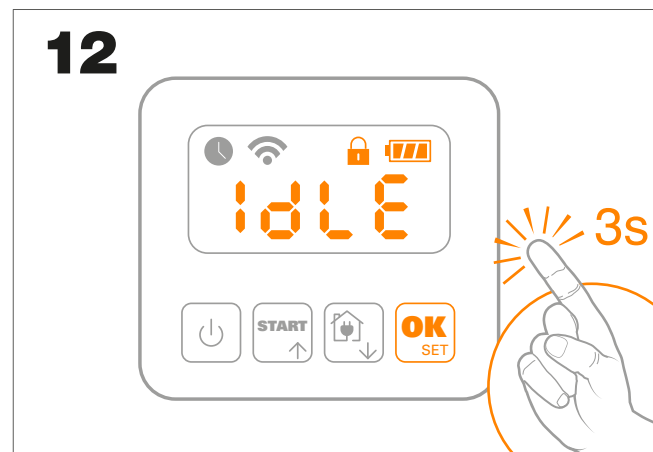

12. Press OK button for 3 seconds

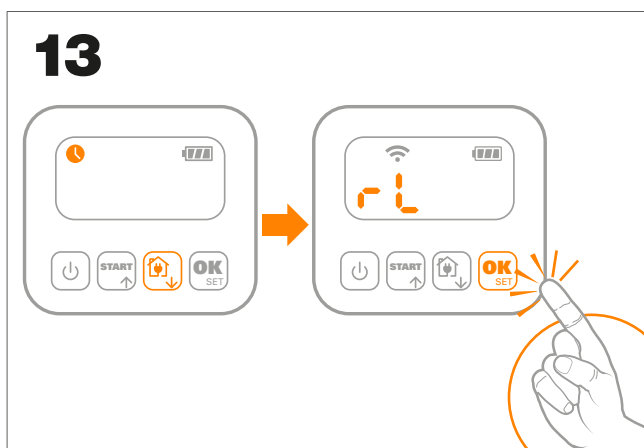

**13.** Press Home and the Wi-Fi symbol  will appear together with the “rL” wording into the display. Then press OK.



**14.** The display will show “SUcc” if everything is fine.

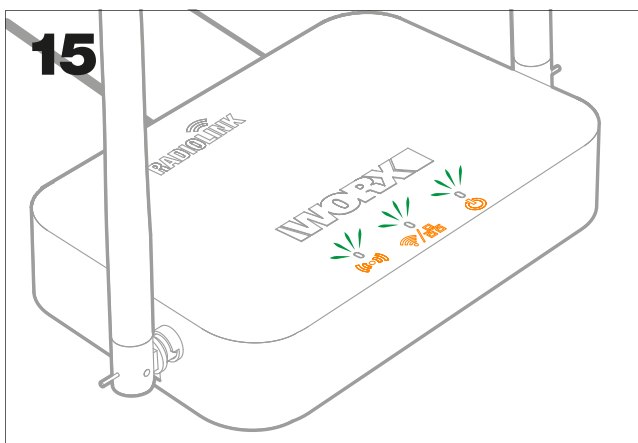

**15.** After a couple of minutes all 3 lights will turn solid green. Please check the trouble shooting section for the different LED colors and their meaning.

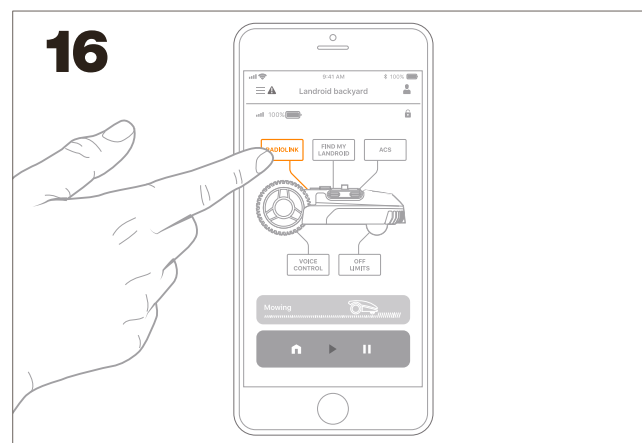

**16.** The Radiolink icon is now active. Touch it to see the status. If the Status shows “error” contact our support team at <https://support.worx-europe.com>



**Landroid L 1000 (WR147E.1)**  
**Landroid L 800 (WR148E)**  
**Landroid M 500 Plus (WR165E)**  
**Landroid M 700 Plus (WR167E)**

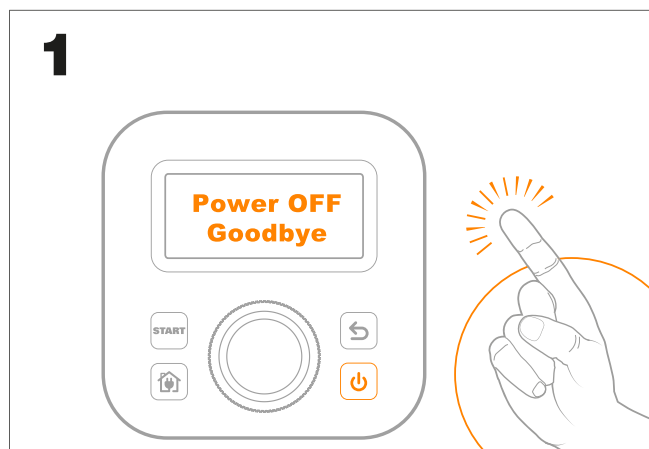

1. Turn off Landroid

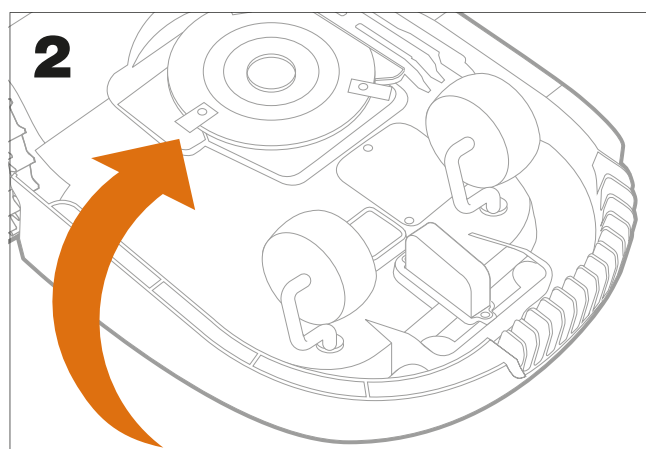

2. Turn Landroid upside down

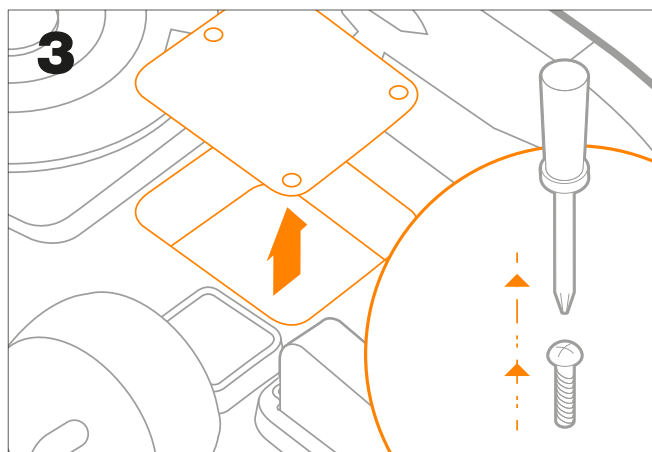

3. Remove the cover using a screwdriver

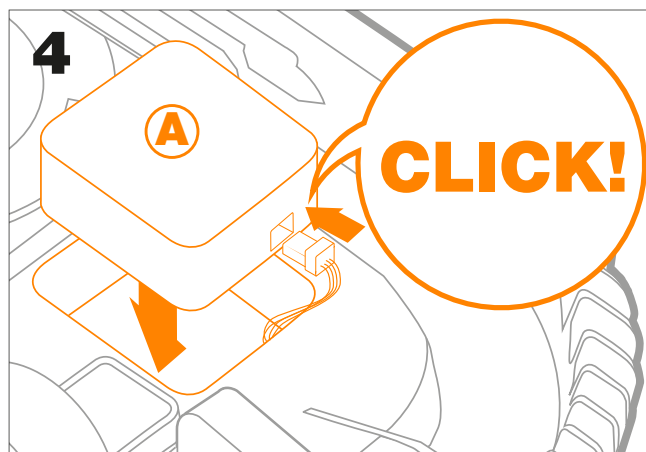

4. Connect RadioLink module to the Landroid's connector till you hear a click and insert it into the slot

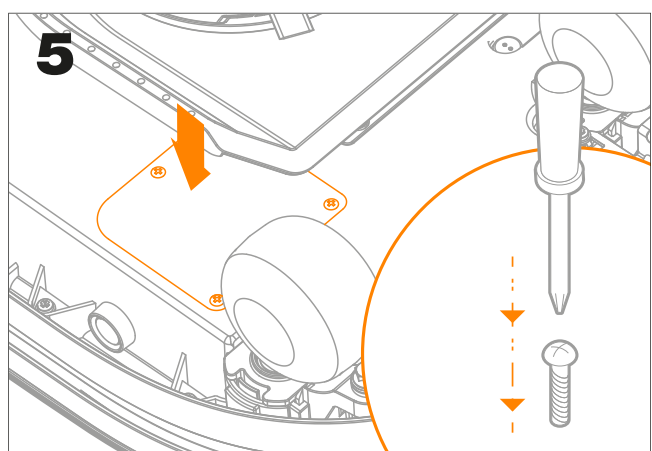

5. Replace the cover using a screwdriver

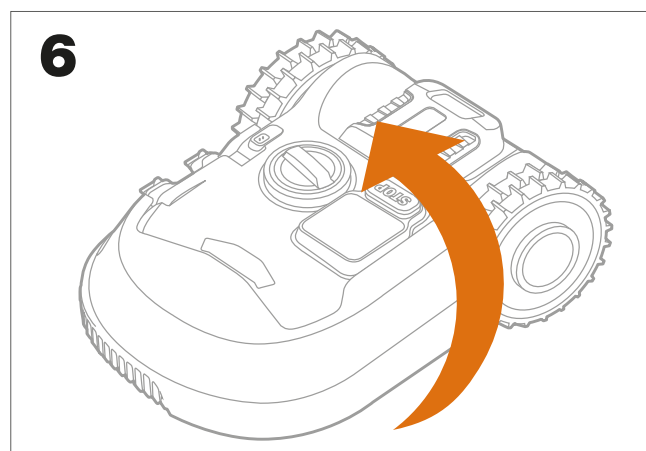

6. Replace Landroid to its position

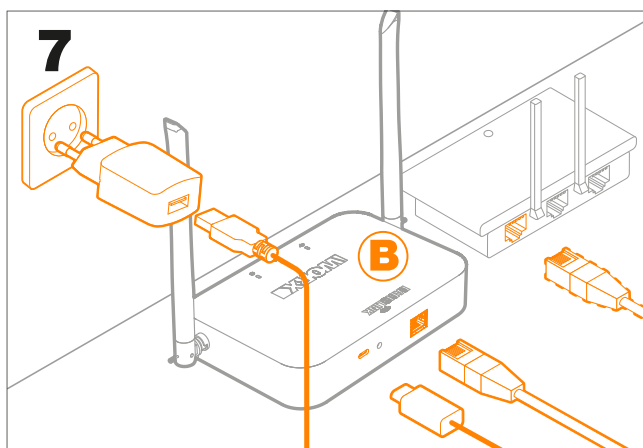

7. Connect the Radiolink Gateway (B) to your router, even if it does not have Wi-Fi, by just connecting the ethernet cable (E)

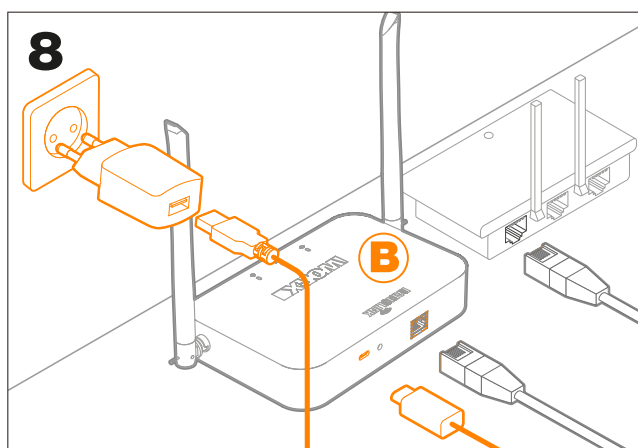

8. Plug the AC adaptor (A) into the main plug and connect it to the Radiolink Gateway (B) by using the cable (D).

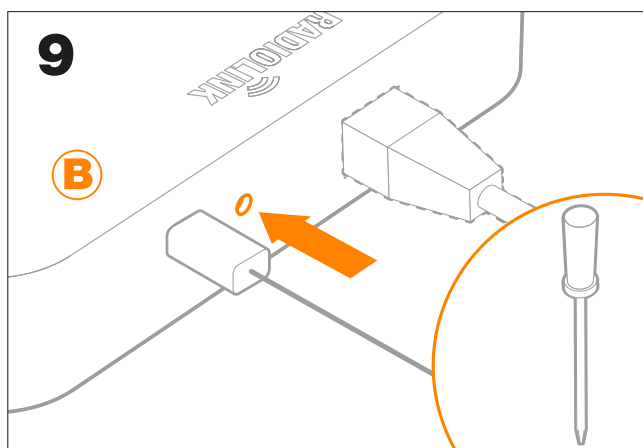

9. The lights will be: UWB (Ultra Wide Band) light is red, Wi-Fi LAN light is green, power light is blue. If not please check trouble shooting guide at the end of this manual.

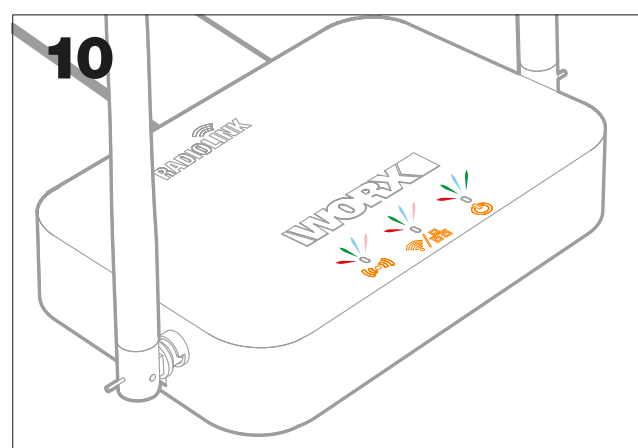

10. Push with a screwdriver in the hole, as per image here above, till you hear a click



11. To access the main menu, rotate the knob clockwise and press the knob to confirm.



12. Rotate the knob to select the menu item "Setup RadioLink", then press the knob to confirm



13. Press the knob to give your ok and start pairing.

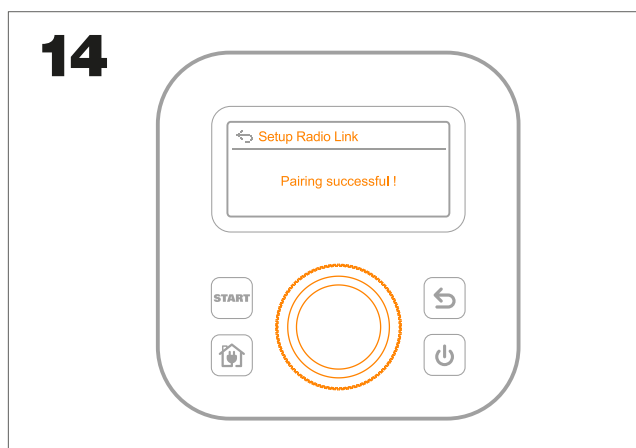

14. Successful pairing.

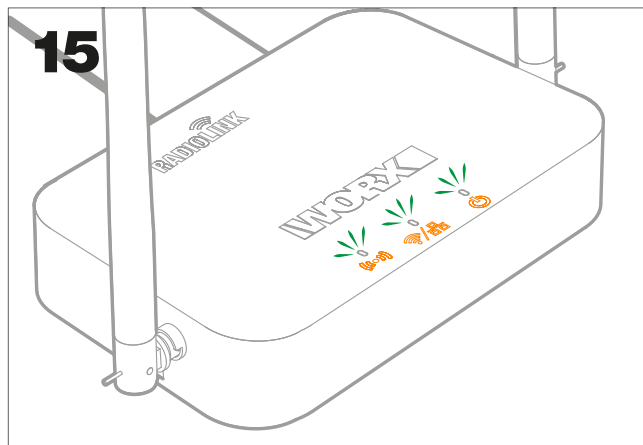

15. After a couple of minutes all 3 lights will turn solid green. Please check the trouble shooting section for the different LED colors and their meaning.

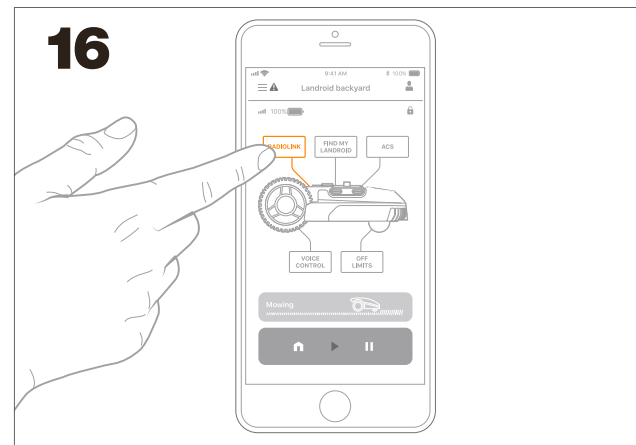

16. The RadioLink icon is now active. Touch it to see the status. If the Status shows "error" contact our support team at <https://support.worx-europe.com>

**Landroid L 1500 (WR153E)**  
**Landroid L 2000 (WR155E)**

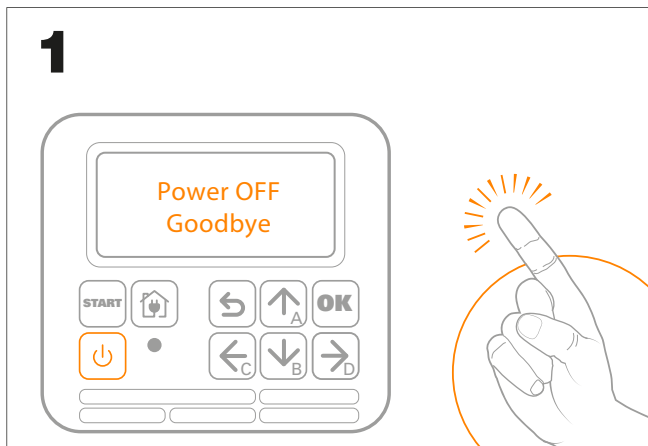

1. Turn off Landroid

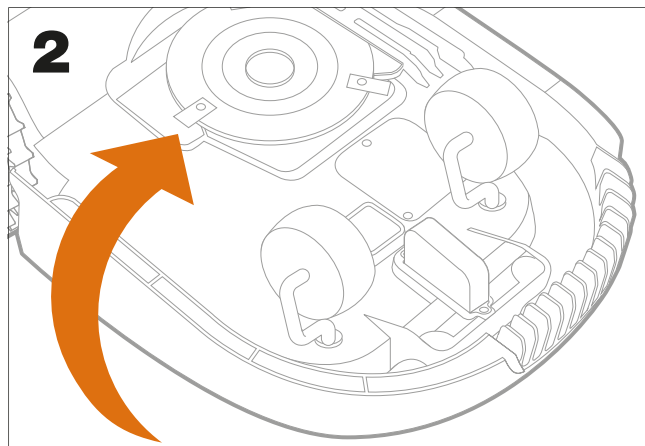

2. Turn Landroid upside down

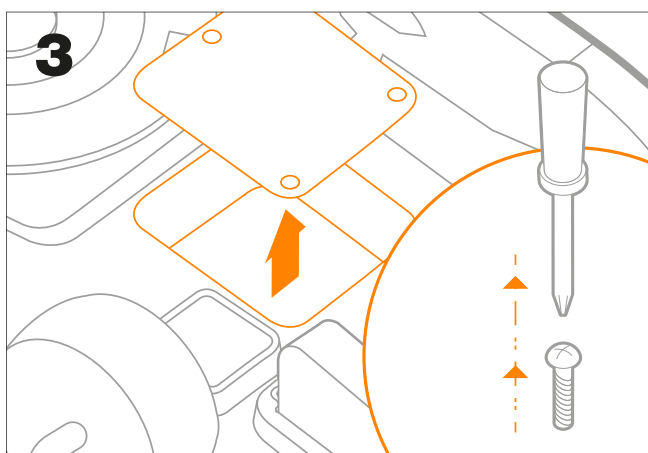

3. Remove the cover using a screwdriver

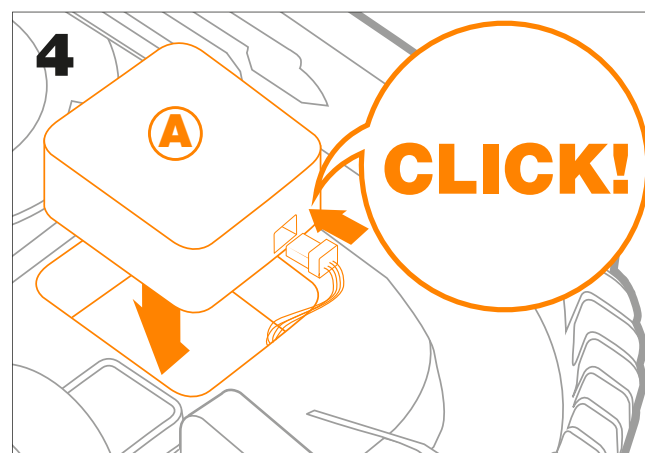

4. Connect RadioLink module to the Landroid's connector till you hear a click and insert it into the slot

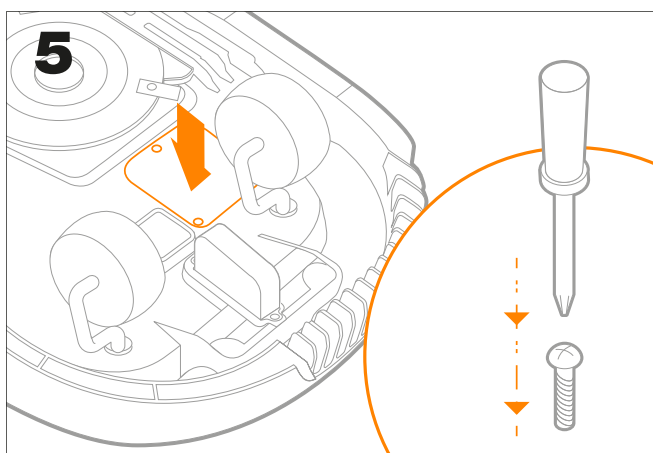

5. Replace the cover using a screwdriver

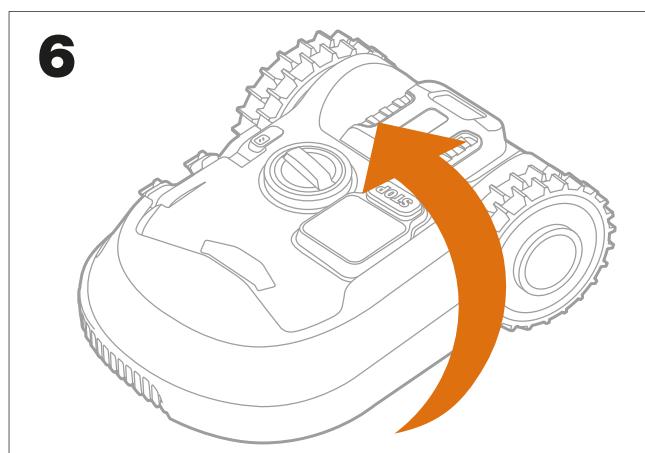

6. Replace Landroid to its position

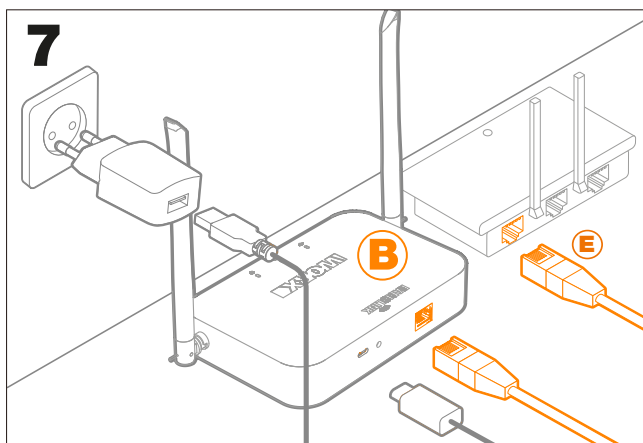

7. Connect the RadioLink Gateway (B) to your router, even if it does not have Wi-Fi, by just , connecting the ethernet cable (E)

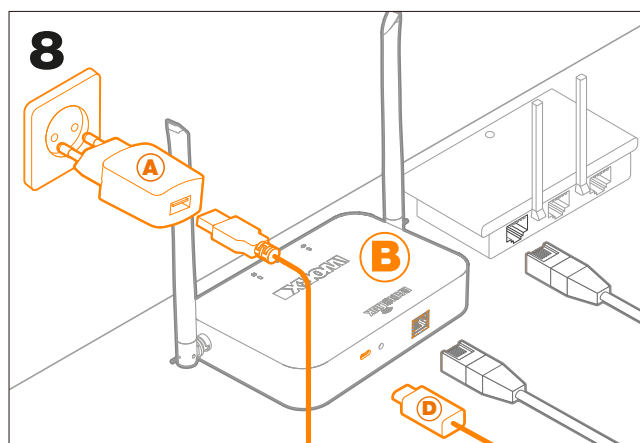

8. Plug the AC adaptor (A) into the main plug and connect it to the RadioLink Gateway (B) by using the cable (D).

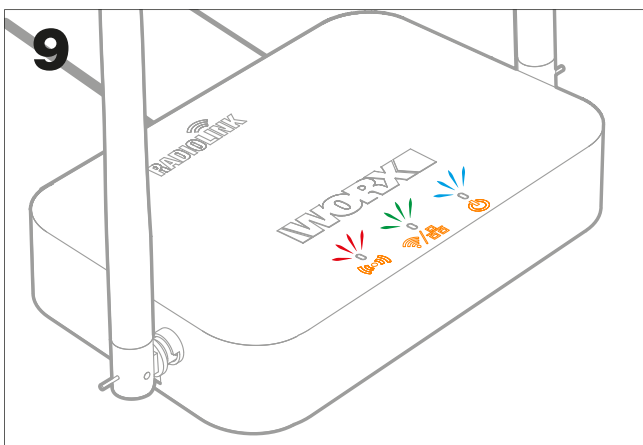

9. The lights will be: UWB (Ultra Wide Band) light is red, Wi-Fi LAN light is green, power light is blue. If not please check trouble shooting guide at the end of this manual.

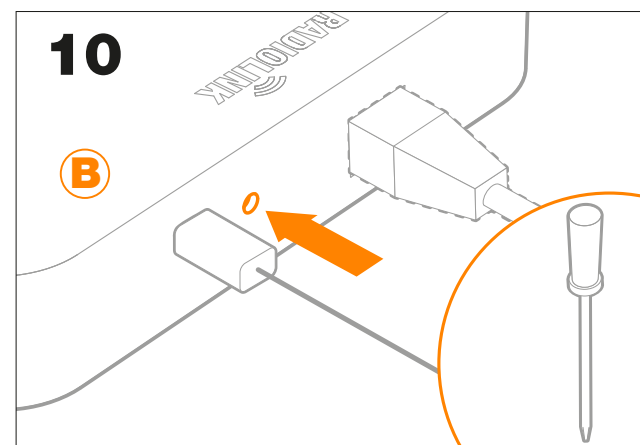

10. Push with a screwdriver in the hole, as per image here above, till you hear a click

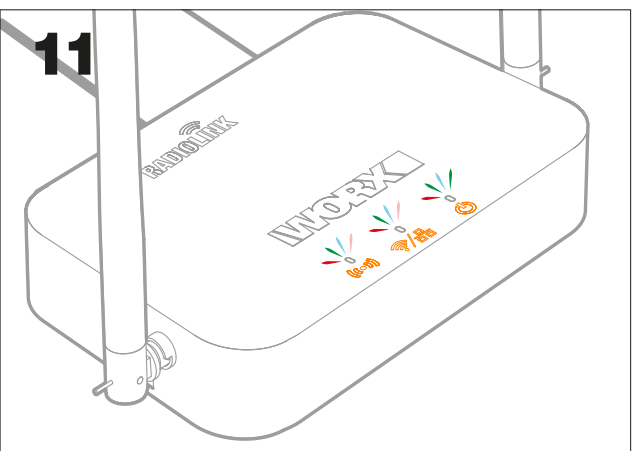

11. The lights will starts blinking multicolor/rainbow



12. Select "General setting" from the display menu and press OK



**13.** Choose “Select RadioLink” by using the arrow and press OK

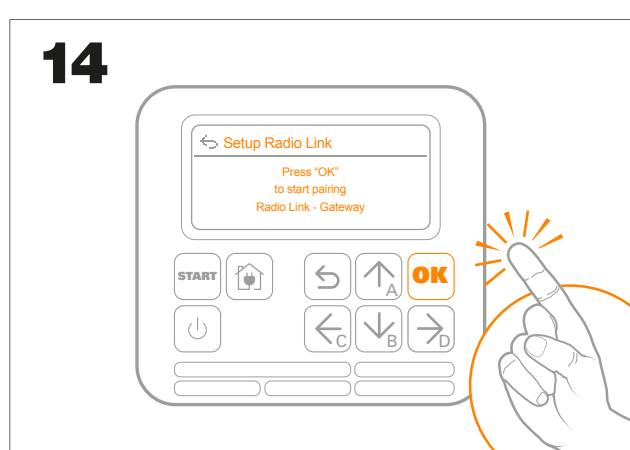

**14.** The wording “Press OK to start pairing RadioLink – Gateway” will appear, press OK



**15.** The message “Pairing successful!” will appear on display

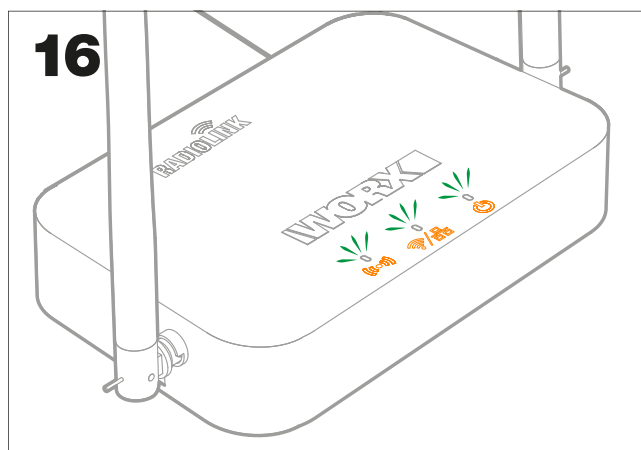

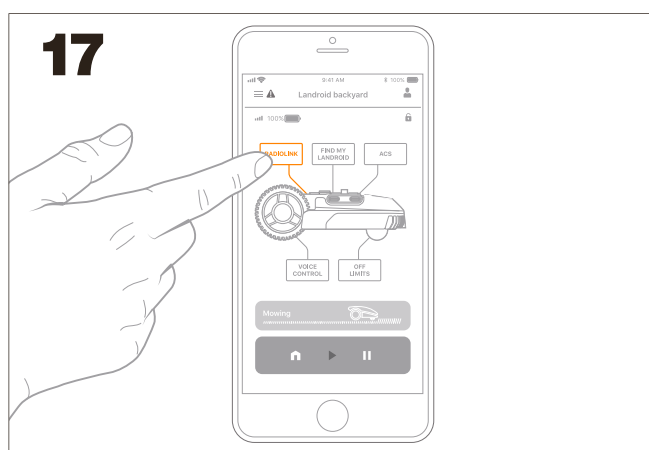

**16.** After a couple of minutes all 3 lights will turn solid green. Please check the trouble shooting section for the different LED colors and their meaning.



**17.** The RadioLink icon is now active. Touch it to see the status.  
If the Status shows “error” contact our support team at <https://support.worx-europe.com>

## Troubleshooting

Symptom		Cause	Action
 <b>Power light is:</b>	solid red	lost connection or “missing” connection	Check internet connection with provider
	solid blue	booting	Nothing to do
	blink purple	transmitting data	Nothing to do
	solid green	successfully connected	Nothing to do
 <b>Wi-Fi/LAN light is:</b>	solid green	connected with ethernet cable / successful connection to the LAN network	Nothing to do
	solid red	ethernet cable disconnected	Make sure cable is properly connected
 <b>UWB (Ultra Wide Band) light is:</b>	solid red	there is no connection or there has not been pairing between RadioLink gateway and Landroid	Verify Landroid is on Verify the module is properly connected Verify the pairing process has been performed If your Landroid came back from service it needs to be paired again
	blink blue	transmitting data	Nothing to do
	solid green	successful connection between RadioLink gateway and Landroid	Nothing to do
	blink yellow	retrying transmitting data because radio channel is busy	Nothing to do

### Technical data for RadioLink Gateway

Rated voltage	DC 5V
Frequency band for sub1G	869.4~869.65MHz
Max. radio-frequency power for sub1G	22 dBm
Frequency band for Wi-Fi	2400~2483.5MHz
Max. radio-frequency power for Wi-Fi	20 dBm
Extreme Temperature	-20~80°C

### Technical data for RadioLink module

Rated voltage	DC 5V
Frequency band for sub1G	869.4~869.65MHz
Max. radio-frequency power	22 dBm
Extreme Temperatures	-20~80°C

### Restrictions on putting into service

There are no restrictions of use.

## Technical data for AC adapter

Rated input data	100-240V~50/60Hz 0.2A
Input AC frequency	50 Hz/60Hz
Output voltage	5.0V
Output current	1.0 A
Output power	5.0 W
Average active efficiency	The average efficiency is larger than 73.62% which is at 115Vac/60Hz and 230Vac/50Hz with 100%, 75%, 50%, 25% rated load This result complies with the DOE VI.
No-load power consumption	0.1W
Weight	30g
Protection class	□ /II
rated maximum ambient temperature	45°C
rated minimum ambient temperature	0 °C



## Declaration of Conformity

We,  
Positec Germany GmbH  
Grüner Weg 10, 50825 Cologne, Germany

Declare that the product  
Description **Radio Link**  
Type **WA0864**  
Function **Wifi signal conversion amplification**

Complies with the following Directives:  
**2014/53/EU, 2011/65/EU & (EU)2015/863**

Standards conform to,  
**EN 301 489-1 V2.1.1, EN 301 489-3 V2.1.1, EN 301489-17 V3.1.1; EN 300 220-1 V3.1.1, EN 300 220-2 V3.1.1, EN 300 328 V2.1.1; EN 50385:2017, EN50665:2017; EN62311:2008; EN 62368-1:2014+A11:2017**

Contact person:  
Name **Marcel Filz**  
Address **Positec Germany GmbH**  
**Grüner Weg 10, 50825 Cologne, Germany**



2020/05/14  
Allen Ding  
Deputy Chief Engineer, Testing & Certification  
Positec Technology (China) Co., Ltd.  
18, Dongwang Road, Suzhou Industrial  
Park, Jiangsu 215123, P. R. China

## Declaration of Conformity

We,  
Positec Germany GmbH  
Grüner Weg 10, 50825 Cologne, Germany

as the representative of Mass Power Electronic Limited in European Union  
Declare that the product (used with the Radio Link)

Description **AC Adapter**  
Type **NBS05B050100VEU**

Complies with the following Directives:  
**2014/35/EU, 2014/30/EU,**  
**2011/65/EU & (EU)2015/863, 2009/125/EC**

Standards conform to  
**EN 62368-1, EN 55032, EN 55035,**  
**EN61000-3-2, EN 61000-3-3, EN50563, (EU)2019/1782, EN 55014-1, EN 55014-2, EN55024**

A handwritten signature in black ink is positioned to the left of a large, grey, stylized CE mark.

2020/03/12  
Allen Ding  
Deputy Chief Engineer, Testing & Certification  
Positec Technology (China) Co., Ltd.  
18, Dongwang Road, Suzhou Industrial  
Park, Jiangsu 215123, P. R. China